

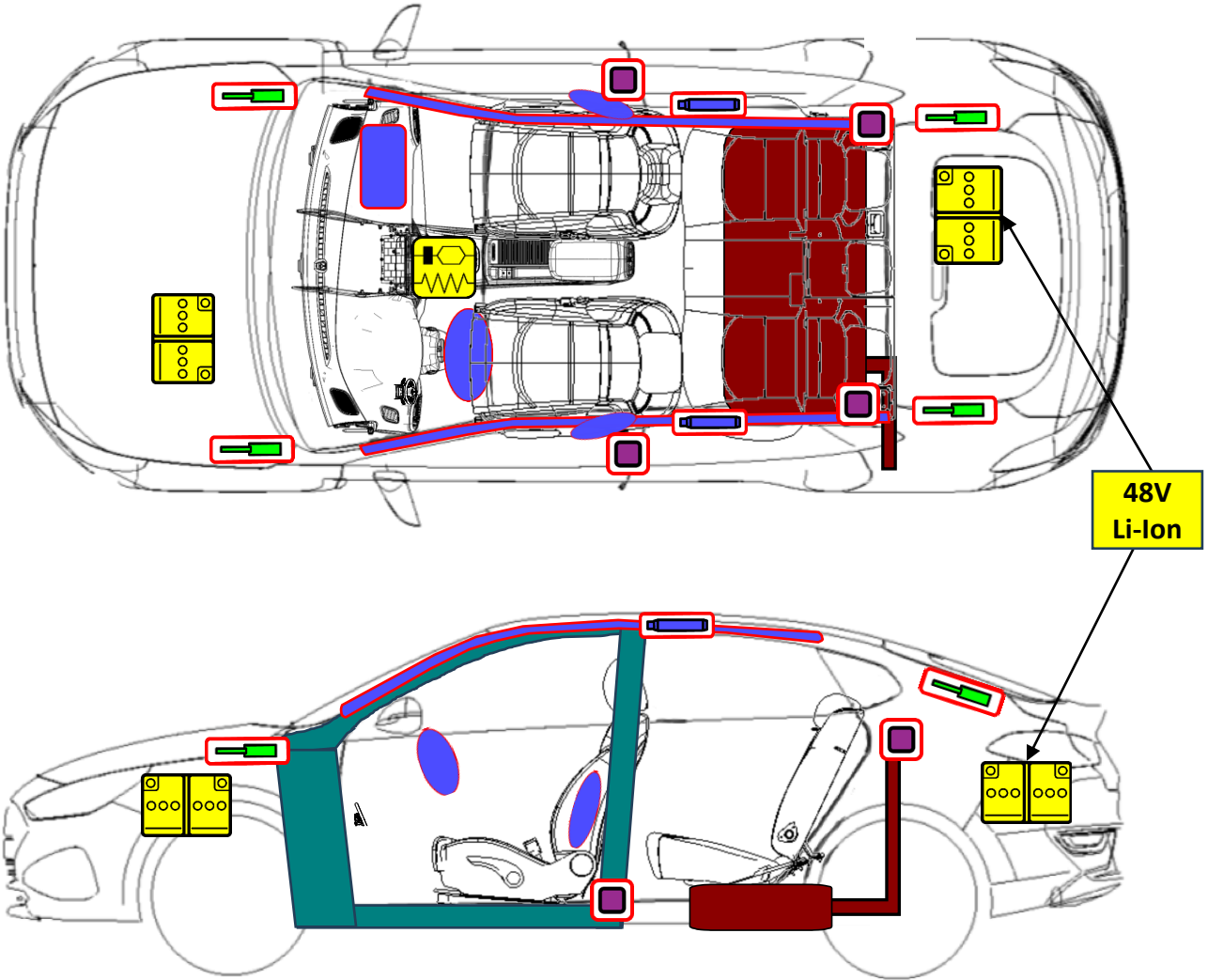

Hyundai i30

Sedan, 4 door
Since 2024



48V
Li-Ion

	Airbag		Stored gas inflator		Seat belt pretensioner		SRS control unit
	Battery low-voltage		Gas strut / Preloaded spring		High strength zone		Fuel tank

1. Identification / recognition



2. Immobilisation / stabilisation / lifting

Immobilization:



1. Chock the wheels and pull the **EPB** switch to set the parking brake.
2. For automatic vehicles the shift button to the park (P) position.

For stabilize vehicle, crib at four points directly under the front and rear pillars using wooden blocks or equivalent objects

Lifting points under the vehicle:

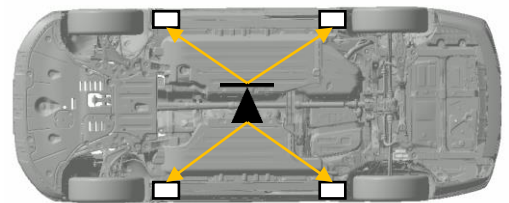

3. Disable direct hazards / safety regulations

Low Voltage 12V battery:



Access:

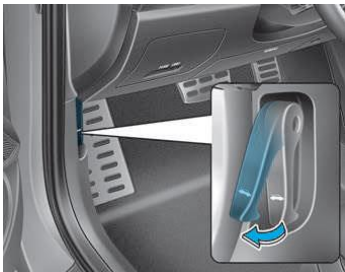

Pull the release lever to unlatch the hood. The hood should pop open slightly.

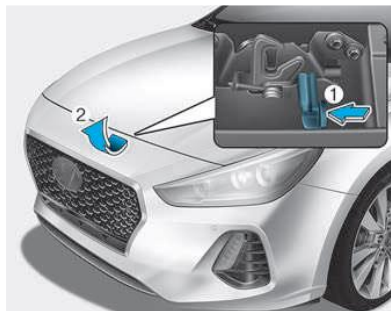

Raise the hood slightly, push the secondary latch up (1) inside of the hood center and lift the hood (2)

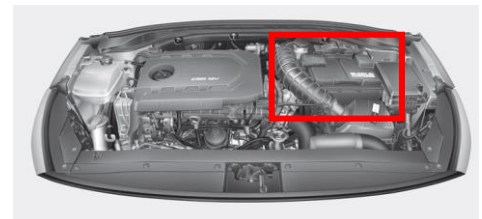

12V Battery in the engine room

Disabling:

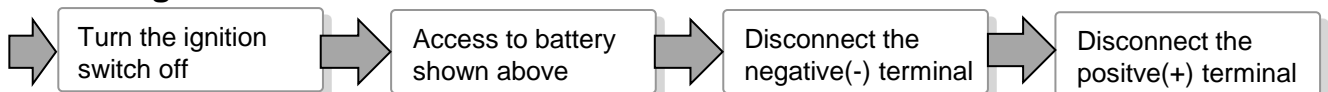

48V [LI ION] Battery:

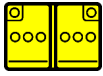

Access:



Open tailgate

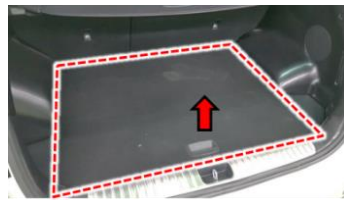

Remove the luggage cover

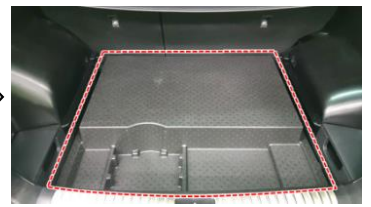

Remove luggage foam



Disabling:

Disconnect 12V battery (shown on page 2) in the hood

Wait 10min and get access to the 48V battery shown above

Disconnect 12V (+) cable from 48V battery pack

Disconnect 48V (-) cable and (+) cable in order and BMS ESTN wire



4. Access to the occupants

Steering column adjustment:

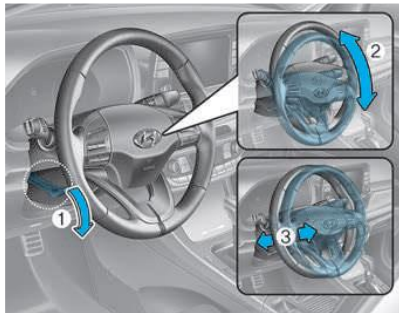

Seat adjustment:

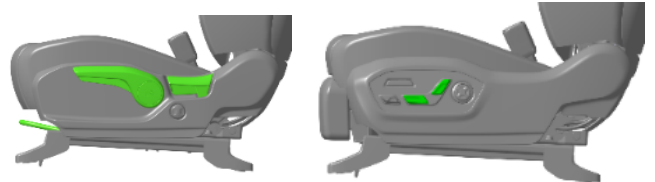

MANUAL

POWER

Glass:

- ① : Laminated
- ②③④ : Tempered

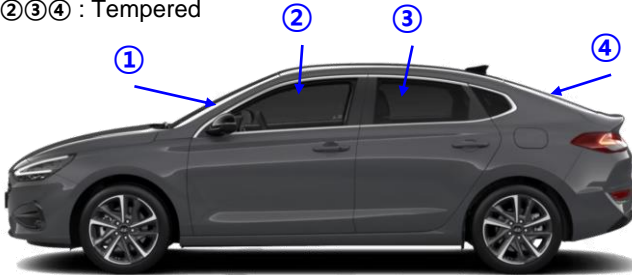

Vehicle body → Hardened Steel

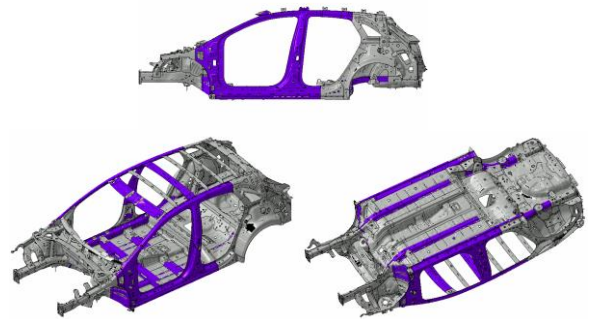

5. Stored energy / liquids / gases / solids

		50l	
		12V	R-1234yf 450g
Li-Ion		48V	



WHEN COOLANT LEAKS FROM THE BATTERY PACK, IT CAN BECOME UNSTABLE WITH RISK OF THERMAL RUNAWAY. CHECK BATTERY PACK TEMPERATURE WITH THERMAL IMAGING CAMERA

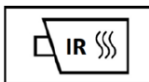

6. In case of fire



Use large amount of water

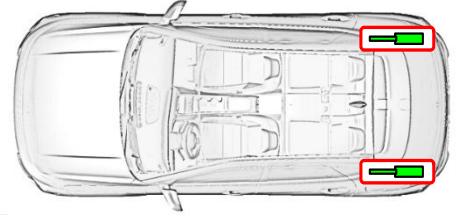

BATTERY RE-IGNITION!

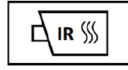

Gas strut!



Risk of missile effect of hood and tailgate.

7. In case of submersion



Do not touch any of the 48V components or cables, as doing so poses an electrocution hazard. Work on the vehicle only after the vehicle has been pulled out of the water.



8. Towing / transportation / storage

OK

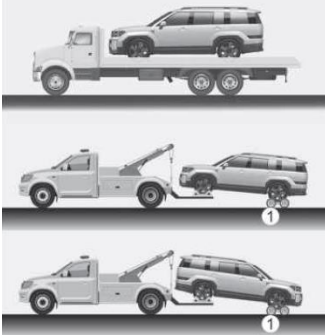

Notice: The use of wheel dollies (1) or flatbed is recommended. Use a wheel lift or flatbed equipment.

Not OK

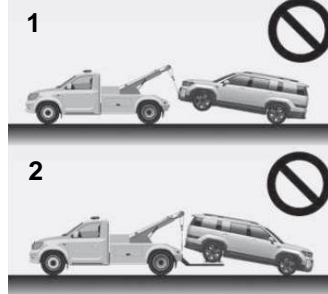

Notice : Do not tow with sling-type equipment (1). Do not tow the vehicle with the front wheels on the ground as this may cause damage to the vehicle (2).

Towing - Hook

Front:

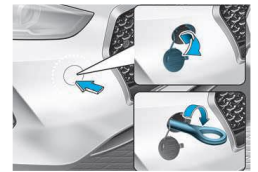

Rear:

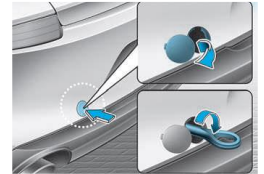

The towing hook is in the tool case in the trunk

9. Important additional information

10. Explanation of pictograms used

	Gasoline vehicle		Fuel tank content gasoline / ethanol		Bonnet
	General warning sign		Air-conditioning component		Boot
	Corrosives		Hazardous to the human health		Flammable
	Explosive		Acute toxicity		Environmental hazard
	Use thermal Infrared camera		Use water to extinguish the fire		Warning, Electricity