

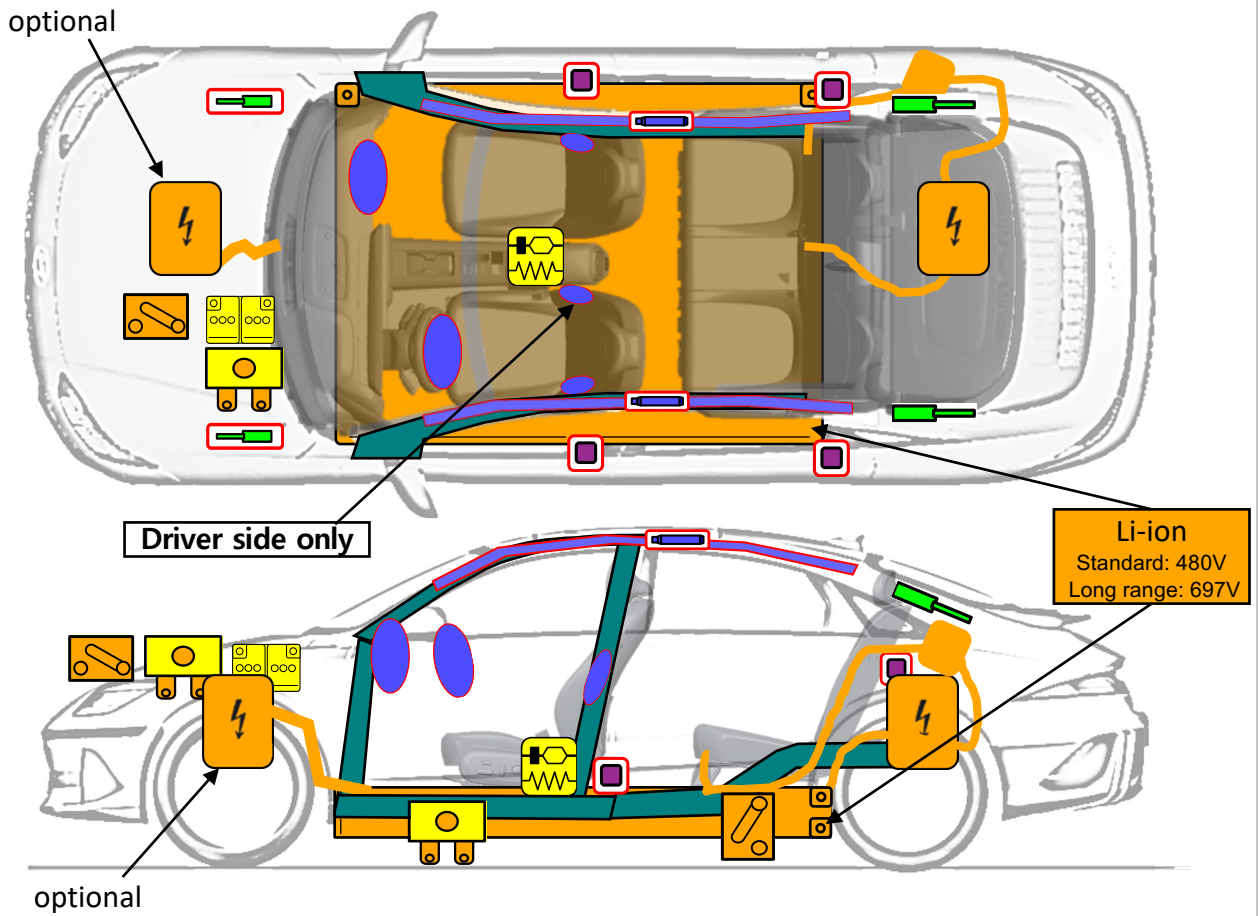

**HYUNDAI IONIQ 6**  
Sedan, 4 doors  
From July 2022



Reserved for holes (paper version)



	Airbag		Stored gas inflator		Seat belt pretensioner		SRS control unit		Pedestrian protection active system
	Automatic rollover protection system		Preloaded spring / Gas strut		High strength zone		Zone requiring special attention		High voltage component
	Battery low-voltage		Ultra-capacitor, low voltage		Fuel tank		Gas tank		Safety value
	Battery pack, high-voltage		High voltage power cable		High voltage device that disconnects high voltage		Fuse box disabling high voltage		High voltage ultra capacitor

## 1. Identification / recognition

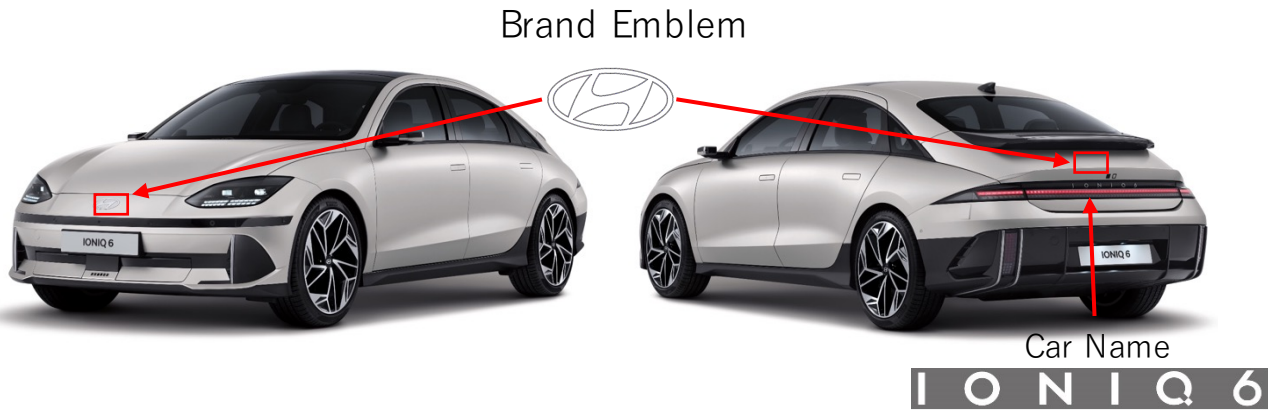

## 2. Immobilisation / stabilisation / lifting

### ■ Immobilisation



1. Chock the wheels and pull the switch to set the parking brake.



2. For automatic transmission vehicles, shift into park(P) gear.

### ■ Lifting points under the vehicle: ■

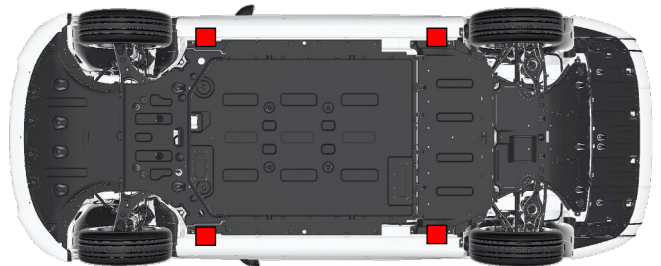

## 3. Disable direct hazards / safety regulations

### ■ Access to the battery



1. Pull the release lever to unlatch the hood. The hood should pop open slightly.



2. Raise the hood slightly, push the secondary latch up (1) inside of the hood center and lift the hood (2)

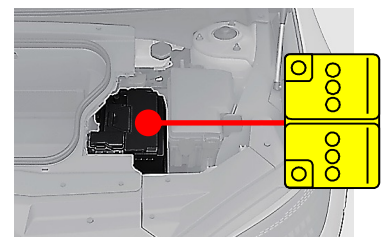

3. Battery in the motor compartment

## Disabling procedure

Low voltage battery (12 V)



① Turn the ignition switch off



② Disconnect the negative(-) terminal



③ Disconnect the positive(+) terminal

High voltage battery



① Open cover of the fuse box in the engine compartment



② Pull up the yellow lever in the high voltage cut-off switch

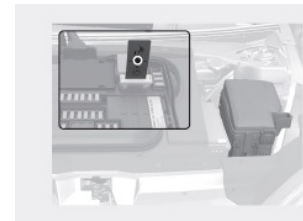

## 4. Access to the occupants

### Seat adjustment

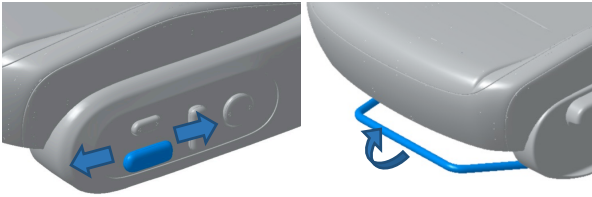

### Door handle

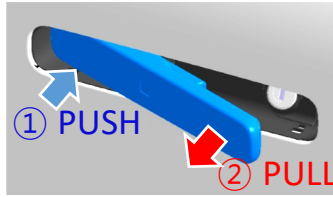

When the door outer handle doesn't pop-out, push the front side inwards.

### Steering column adjustment

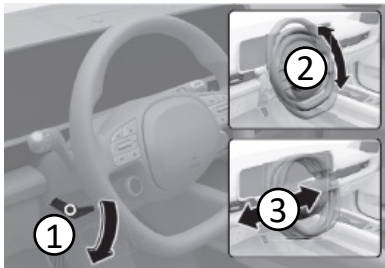

### Vehicle Body

Hardened Steel  
(100K↑)

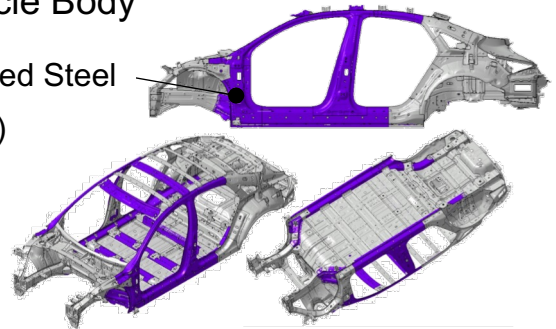

### Glass



- 1 : Laminated
- 2 : Tempered, Laminated(OPT)
- 3 : Tempered, Laminated(OPT)
- 4 : Tempered

## 5. Stored energy / liquids / gases / solids

	Standard : 480 V Long Range : 697 V								
	12 V								
		w/o heat pump	with heat pump						
	R-134a	750g	950g						
	R-1234yf	700g	900g						



When coolant leaks from the battery pack, it can become unstable with risk of thermal runaway. Check battery pack temperature with thermal imaging camera.

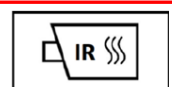

## 6. In case of fire



Use large amount of water



**BATTERY RE-IGNITION!**

■ Gas Strut

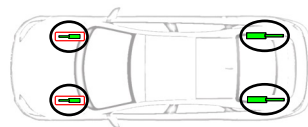

- Risk of missile effect of hood and tailgate.

## 7. In case of submersion



Do not touch any of the high-voltage components or cables including the high voltage cut-off switch, as doing so poses an electrocution hazard. Work on the vehicle only after the vehicle has been pulled out of the water.

## 8. Towing / transportation / storage

OK :

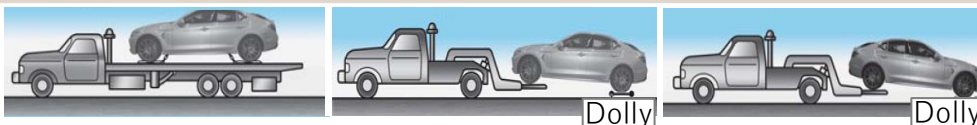

Notice: A towed AWD (All Wheel Drive) vehicle must have all its wheels off the ground. Keep it on a flatbed, tow truck or use dollies

Not OK :



Notice : Do not tow with sling-type equipment. Use a wheel lift or flatbed equipment. Do not tow the vehicle with the rear wheels on the ground as this may cause damage to the vehicle.

## 10. Explanation of pictograms used

	Electric vehicle		Warning, Electricity
	General warning sign		Flammable
	Corrosives		Hazardous to the human health
	Explosive		Acute toxicity
	Air-conditioning component		Warning; low temperature
	Use thermal Infrared camera		Use water to extinguish the fire
	Bonnet		