

# i20



C8MS4-BC000



- The functions and services described in this guide are subject to change without prior notice for performance improvement. If the system software is updated, the screenshots in this guide may appear different than the actual images on the system.
  - The functions and services described in this guide may differ from those provided in your vehicle. For precise information related to your vehicle, refer to the owner's manual or catalogue of your vehicle.
  - The design and specification of the system may change without prior notice for performance improvement.
  - This multimedia system contains open source software, including without limitation, software distributed and/or modified under the GNU General Public licence, Version 2, June 1991, and the GNU lesser General Public Licence, Version 2.1, February 1999.
- For additional information and to obtain related materials including without limitation, the previous referred to licences and software, please contact us at [MOBIS\\_OSSrequest@mobis.co.kr](mailto:MOBIS_OSSrequest@mobis.co.kr)



- All Map Database cannot be copied without permission.
- Copyright Notice: © 1987 - 2018 HERE.
- You may not otherwise reproduce, modify and distribute the content without the prior written consent of HERE Technologies and HYUNDAI MnSOFT, Inc..

# Available information for users



## Car Multimedia System User's Manual (PDF)

This guide introduces your system's functions and explains how to use them. To use your system correctly and safely, read this guide before using the system.



## Car Multimedia System Quick Reference Guide (print)

This guide combines key information into a quick reference. Use this guide to refer to descriptions and instructions more quickly and easily.



## Quick guide

This guide is the help built into the system. You can access basic information on how to control the system and a brief description of major functions directly on the system screen.

- How to access the guide: On the Home screen, touch **All menus ► Quick guide**.

For safety, this quick guide will not be displayed while the vehicle is moving. Park your vehicle in a safe location before accessing the quick guide.

# Symbols used in this guide



Warning

Indicates important information related to user safety. Failure to follow warnings may result in death or serious personal injury.



Caution

Indicates important information related to user safety. Failure to follow cautions may result in personal injury, or damage or malfunction your vehicle.



Note

Indicates helpful information for convenient use.

\*if equipped

Indicates descriptions for optional features.

This guide covers all specifications, including all trim models and optional specifications. It may include descriptions for features that are not equipped in your vehicle.

# Safety warnings

For safety, follow the instructions below. Failure to do so may increase the risk of a traffic accident, which may result in death or personal injury.

## About driving

---

Do not operate the system while driving.

- Driving while distracted may result in a loss of vehicle control, potentially leading to an accident, severe personal injury, or death. The driver's primary responsibility is the safe and legal operation of a vehicle, and any handheld devices, equipment, or vehicle systems which divert the driver's attention from this responsibility should never be used during operation of the vehicle.

Follow traffic regulations while driving.

- Driving only with the guidance of the navigation system may cause violation of traffic regulations, which may lead to a traffic accident.

Depend on your vehicle's speedometer when checking your driving speed.

- The speed displayed in the navigation screen may differ from your actual speed.

Avoid watching the screen while driving.

- Driving while distracted may lead to a traffic accident.
- Stop your vehicle in a safe location before using functions that require multiple operations.

Stop your vehicle first before using your mobile phone.

- Using a mobile phone while driving may lead to a traffic accident.
- If necessary, use the Bluetooth Handsfree feature to make calls and keep the call as short as possible.

Keep the volume low enough to hear external sounds.

- Driving without the ability to hear external sounds may lead to a traffic accident.
- Listening to a loud volume for a long time may cause hearing damage.

When looking for emergency services, such as hospitals or fire stations, do not depend solely on the navigation system.

- Some emergency services may not be included in the navigation map. Locate nearby emergency services in advance so you can take the proper action quickly in an emergency situation.

## **About handling the system**

---

Do not disassemble or modify the system.

- Doing so may result in an accident, fire, or electric shock.

Do not allow liquids or foreign substances to enter the system.

- Liquids or foreign substances may cause noxious fumes, a fire, or a system malfunction.

Stop using the system if it malfunctions, such as no audio output or display.

- If you continue using the system when it is malfunctioning, it may lead to a fire, electric shock, or system failure.

## **Note**

---

If you experience any problems with the system, contact your place of purchase or dealer.

# Safety cautions

For safety, follow the instructions below. Failure to do so may result in personal injury or damage to the system.

## About operating the system

Use the system with the engine running.

- Using the system for a long time when the engine is stopped may discharge the battery.

Do not install unapproved products.

- Using unapproved products may cause an error while using the system.
- System errors caused by installing unapproved products are not covered under the warranty.

## About handling the system

Do not apply excessive force to the system.

- Excessive pressure on the screen may damage the LCD panel or the touch panel.

When cleaning the screen or button panel, make sure to stop the engine and use a soft, dry cloth.

- Wiping the screen or buttons with a rough cloth or using solvents (alcohol, benzene, paint thinner, etc.) may scratch or chemically damage the surface.

If you attach a liquid-type air freshener to the fan louvre, the surface of the louvre may become deformed due to the flowing air.

## Note

If you experience any problems with the system, contact your place of purchase or dealer.



# Cautions when using an SD card



## Caution

---

The SD card installed in the system contains map data and software necessary for navigation. Be careful not to damage the SD card.

- Remove the SD card only when you update the system.
- Stop the engine before removing or re-inserting the SD card. Removing or re-inserting the SD card while the system is operating may cause an error or damage the SD card or the system.
- The SD card is intended for storing map data and update files only. Do not add or delete files on the SD card.
- Do not format the SD card arbitrarily.

# Contents

## 1 System overview

Component names and functions	1-2
Turning the system on or off	1-5
Controlling the touch screen	1-7
Getting to know the Home screen	1-8
Getting to know the rear view screen	1-9

## 2 Useful features

Setting up My Menu	2-2
Editing My Menu	2-2
Using Voice memo	2-2
Using phone projection	2-3
Connecting your iPhone via Apple CarPlay	2-4
Connecting your Android smartphone via Android Auto	2-6

## 3 Radio

Turning on the radio	3-2
Changing the radio mode	3-3
Scanning for available radio stations	3-3
Searching for radio stations	3-4
Saving radio stations	3-4
Listening to saved radio stations	3-5

## 4 Media player

Using the media player	4-2
Controlling the media player	4-3
Using the USB mode	4-5
Listening to music	4-5
Using the iPod mode	4-7
Using the AUX mode	4-10

# 5

## Navigation

Finding a route quickly	5-2
Getting to know the navigation screen	5-5
Adjusting the navigation sound volume	5-7
Cancelling the navigation	5-7
Finding a route with various search methods	5-8
Searching for locations by address	5-9
Searching for locations by POI category	5-9
Searching for Hyundai services	5-11
Searching for locations by coordinates	5-11
Selecting a location from previous destinations	5-12
Searching for locations by personal POI group	5-12
Using helpful navigation options	5-14
Finding another route	5-14
Making a diversion	5-14
Avoiding specific roads	5-15
Adding waypoints	5-15
Viewing information	5-17
Registering locations	5-19
Saving your current location	5-19
Searching for and saving locations	5-19
Saving your favourite locations	5-20
Using the saved locations	5-21
Using your favourite locations	5-21
Editing saved locations	5-22
Deleting saved locations	5-22

Using the live information service	5-23
Viewing traffic information	5-23
Searching for locations by live POI category	5-24
Viewing weather information	5-24
Searching for parking areas	5-25
Searching for petrol stations	5-26
Updating the map	5-26
Changing navigation settings	5-27

# 6

## Bluetooth

Connecting Bluetooth devices	6-2
Pairing devices with your system	6-2
Connecting a paired device	6-4
Disconnecting a device	6-5
Deleting paired devices	6-5
Using a Bluetooth audio device	6-6
Using a Bluetooth phone	6-7
Making a call	6-8
Answering calls	6-11
Using options during a call	6-12
Setting up your favourites list	6-14

# 7

Setting sounds	7-2
Setting the system sound	7-2
Setting the system screen	7-4
Setting the screen saver	7-4
Setting Bluetooth	7-5
Setting up Wi-Fi	7-5
Setting the system environments	7-6
Setting the display language	7-6
Setting the time and date	7-7
Setting the keyboard	7-7
Setting advanced options	7-8
Viewing system information	7-9
Updating system software and map data	7-9

# Settings

# 8

Solutions	8-2
Sound and display	8-2
USB playback	8-4
iPod/iPhone playback	8-5
AUX mode	8-6
Bluetooth connection	8-7
Phone projection	8-8
System operation	8-9
Navigation system operation	8-10

# Troubleshooting

# 9

System status icons	9-2
FAQ	9-3
System specifications	9-8
Index	9-13

# Appendix

# System overview



Component names and functions

Turning the system on or off

Controlling the touch screen

Getting to know the Home screen

Getting to know the rear view screen

# Component names and functions

Control panel

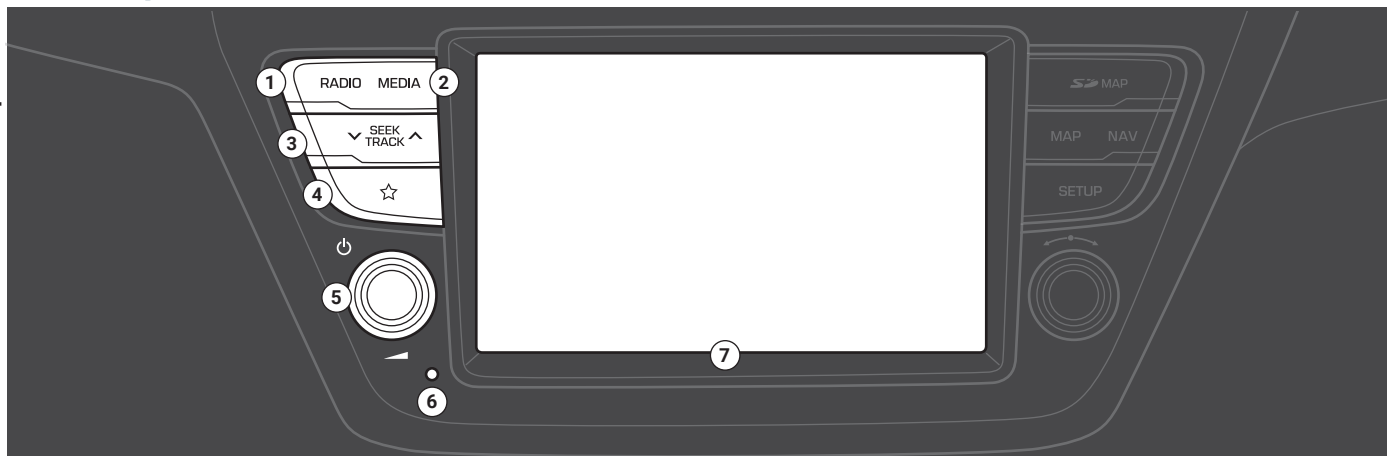

## 1 RADIO button

- Press to turn on the radio. While listening to the radio, press to change the radio mode.

## 2 MEDIA button

- Press to play content from a media storage device.
- If you have multiple media storage devices, select one from the media selection window.

## 3 SEEK/TRACK button

- While using an AV function, change the station/track/file (except for the AUX mode).
- While listening to the radio, press and hold to search for a station.
- While playing media, press and hold to rewind or fast forward (except for the AUX and Bluetooth audio modes).

## 4 Custom button (☆)

- Press to use a custom function.

## 5 Power button (⏻)/Volume knob (◀▶)

- Press to turn AV (radio/media) on or off.
- Press and hold to turn off the screen and the sound.
- Turn to the left or right to adjust the system sound volume.
- While the navigation guidance is playing, turn to adjust the sound volume.

## 6 Reset button

## 7 Touch screen ▶ See p.9-11 "Display."

Note: Depending on vehicle models and specifications, the illustration above may differ from the product's actual appearance and layout.

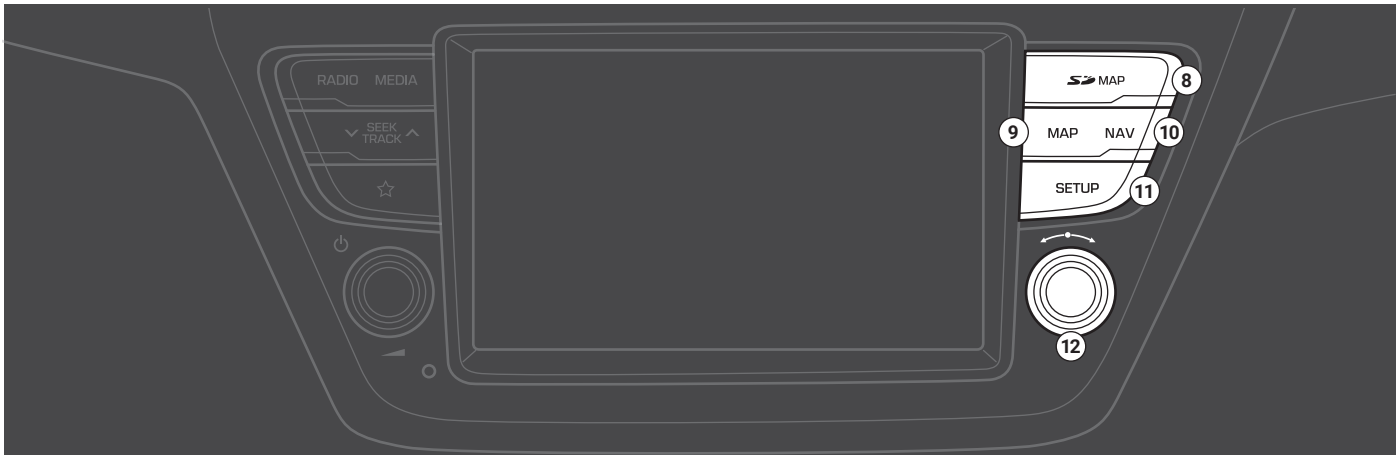

**8 SD card slot**

**9 MAP button**

- Press to view a map of your current location.

**10 NAV button**

- Press to access the navigation menu screen.

**11 SETUP button**

- Press to access the settings screen.

**12 Tune knob/File knob/Enter button (↔)**

- While listening to the radio, turn to adjust the frequency or change the station.
- While playing media, turn to search for a track/file.
- During a search, press to select the current track/file.

Note: Depending on vehicle models and specifications, the illustration above may differ from the product's actual appearance and layout.

- 1 Voice recognition button** (🗣️)
  - Press to start voice recognition of a connected smartphone via phone projection.
  - Press and hold to end voice recognition.
- 2 Mode button** (🔄)
  - Press to switch between AV (radio/media) modes.
  - Press and hold to turn AV (radio/media) on or off.
- 3 Volume lever** (🔊 +/🔊 -)/Mute button
  - Push up or down to adjust the volume.
  - Press to mute or unmute the system (except for the navigation).
  - While playing media, press to pause or resume playback (except for the iPod mode).
- 4 Up/Down lever** (⤴️/⤵️)
  - While using an AV function, change the station/track/file (except for the AUX mode).
  - While playing media, push and hold to rewind or fast forward (except for the AUX and Bluetooth audio modes).
- 5 Call/Answer button** (📞)
  - Press to start connecting a mobile phone via Bluetooth.
  - After a Bluetooth phone connection is made, press to access your call history. Press and hold to dial the most recent phone number. When a call comes in, press to answer the call.
  - During a call, press to switch between the active call and the held call. Press and hold to switch the call between the system and the mobile phone.
- 6 Call end button** (📞)

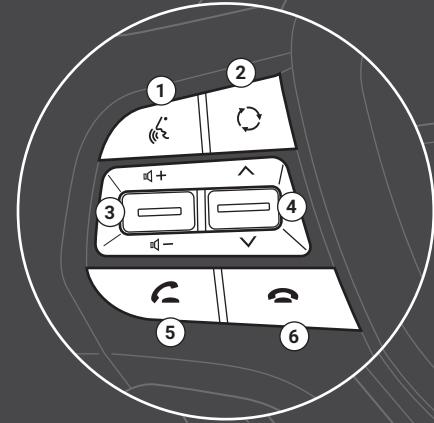

Note: Depending on vehicle models and specifications, the illustration above may differ from the product's actual appearance and layout.



# Turning the system on or off

- 1 To turn on the system, start the engine.
- 2 When the safety warning appears, read it and touch **Confirm**.
  - To change the display language, touch **Language**.

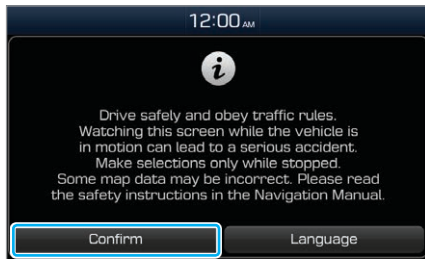

- If you do not want to use the system while driving, you can turn off the screen and the sound by pressing and holding the [⏻] button on the control panel. To use the system again, press the [⏻] button.

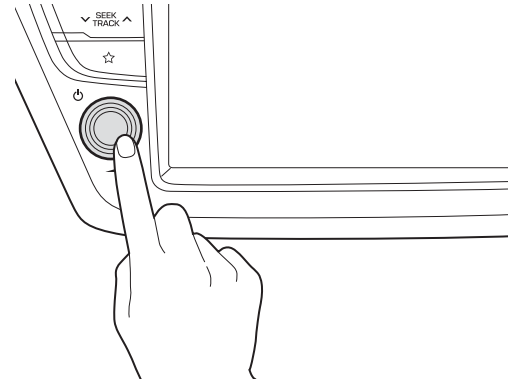

The system turns off when you stop the engine (ACC Off).

- When you turn back on the system, the previous mode and settings will remain intact.

## ⚠ Warning

- Some functions may be disabled for safety reasons while the vehicle is moving. They work only when the vehicle stops. Park your vehicle in a safe location before using any of them.
- Stop using the system if it malfunctions, such as no audio output or display. If you continue using the system when it is malfunctioning, it may lead to a fire, electric shock, or system failure.

## ⚠ Caution

- You can turn on the system when the key ignition switch is placed in the "ACC" or "ON" position. Using the system for an extended period without the engine running drains the battery. If you plan on using the system for a long time, start the engine.

- If you turn on your system without starting the engine, a battery warning will appear. Once the engine starts, the battery warning will disappear.

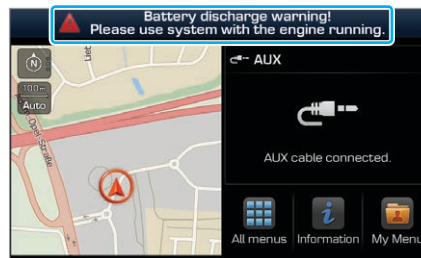

## 📄 Note

To avoid having audio play at an excessive volume when you start the engine, adjust the volume level before stopping the engine. You can also set the system to decrease the volume level automatically. On the Home screen, touch **All menus** ► **Settings** ► **Sound** ► **Loudness** and activate the **Volume limitation on startup** option.

# Controlling the touch screen

Your system is equipped with a touch screen. You can perform various functions via touch inputs.

## Caution

- Do not apply excessive pressure to the touch screen or touch it with a pointed object. Doing so may damage the touch screen.
- Do not let any electrically conductive material contact the touch screen. A shock from static electricity may cause the system or the touch screen to malfunction.

## Note

If you wear regular gloves, you will not be able to control the touch screen. Remove your gloves or wear gloves designed for use with a touch screen.

## Touch

Touch an object lightly and lift your finger. You can perform a function or select an option.

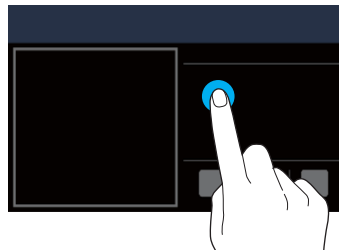

## Touch and hold

Touch an object and hold it for at least one second without lifting your finger. You can rewind or fast forward media by touching and holding an appropriate button.

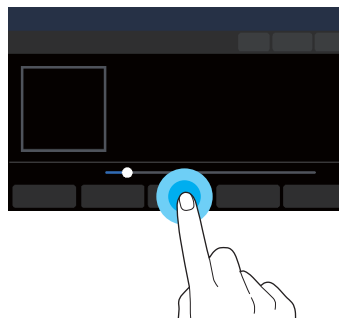

## Drag

Touch and hold an object, drag it, and then drop it on a new location. You can move the selected object to another location or skip ahead or replay part of a song.

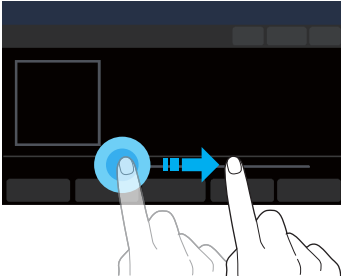

## Swipe

Swipe the screen lightly in an appropriate direction. This is an easy way to scroll through a menu or list quickly.

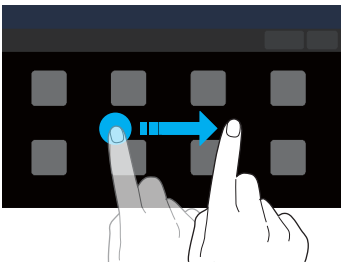

# Getting to know the Home screen

From the Home screen, you can access various functions.



- 1 Current time
- 2 System status icons ▶ See p.9-2 "System status icons."
- 3 AV information. Touch to activate the corresponding AV mode in full screen.
- 4 Map. Touch to view in full screen.
- 5 Access the All menus screen.
- 6 Access the Information screen. ▶ See p.5-23 "Using the live information service."
- 7 Access the My Menu screen. ▶ See p.2-2 "Setting up My Menu."



## Note

- To move to the Home screen from another screen, touch .
- If an SD card is not inserted into your system, the map will not be displayed on the Home screen.

## Getting to know the rear view screen

When you put the transmission shift lever in the "R" (Reverse) position while the engine is running, the system screen will automatically display what is behind you.

The rear view and the parking guides provide a safer experience when you park your vehicle.



- **Driving direction lines (yellow) 1 2**  
These lines show the directions of the vehicle according to the steering angle.
- **Neutral direction lines (blue) 3**  
These lines indicate your vehicle's expected path with the steering wheel in the neutral position. It can help you determine whether the vehicle is in the correct position in a parking space and prevent you from parking too close to the next vehicle.
- **Crash warning lines (red) 4**  
These lines are to prevent a collision.

## Warning

When reversing, make sure to follow the guidelines below:

- Before entering your vehicle, always check the area behind your vehicle.
- Do not solely rely on the rear view camera when reversing. Always ensure that it is safe to reverse by checking behind you and looking in the rearview mirrors.
- Always reverse slowly and stop immediately if you suspect that a person, especially a child, might be behind you.

## **Caution**

---

The distance shown in the rear view screen may differ from the actual distance. For safety, be sure to visually check the rear, left, and right sides of your vehicle.

## **Note**

---

- The rear view screen remains active while you are reversing. When you move the transmission shift lever to any position other than the "R" (Reverse) position after reversing, the rear view screen will be deactivated and the system will display the previous screen automatically.
- As you steer your vehicle, the parking guides change accordingly to indicate your vehicle's path.



- Depending on vehicle models, the steering-interactive parking guides may not be supported.
- If an object comes too close to your vehicle as you are reversing, a warning beep will sound. To prevent an accident that might result if you do not hear the beep, you can set the system to decrease the volume level of any media playing automatically when the vehicle is in reverse. On the Home screen, touch **All menus ► Settings ► Sound ► Loudness ► Reverse warning priority**.

# Useful features

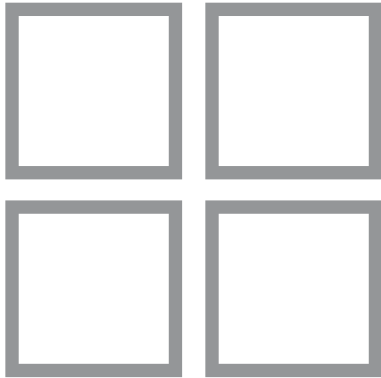

Setting up My Menu

Using Voice memo

Using phone projection

2

## Setting up My Menu

Add your frequently used functions or favourites to My Menu to access them quickly from the Home screen. You can add up to 24 items to My Menu.

### 1 On the Home screen, touch **My Menu** ► **Add to My Menu**.

- If you have already added items, on the My Menu screen, touch **Menu** ► **Add**.

### 2 Select items to add and touch **Add** ► **Yes**.

## Editing My Menu

You can rearrange the items added to My Menu.

### 1 On the Home screen, touch **My Menu** ► **Menu** ► **Rearrange**.

### 2 Drag an item to a desired location.

You can delete the items added to My Menu.

### 1 On the Home screen, touch **My Menu** ► **Menu** ► **Delete**.

### 2 Select items to delete and touch **Delete** ► **Yes**.



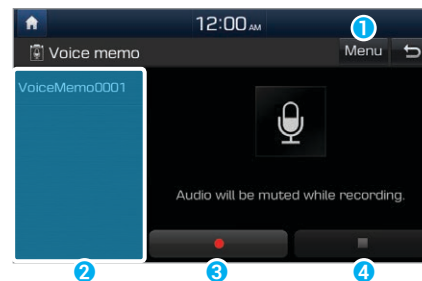

## Using Voice memo

You can record voice memos using the microphone installed in your vehicle and play voice memos on your system.

On the Home screen, touch **All menus** ► **Voice memo**.





- 1 Display the options list.
  - **Delete:** Delete voice memos.
  - **Save to USB:** Save voice memos to a USB storage device. This option is available only for USB storage devices formatted in FAT16/32 formats.
  - **Memory:** View information on the storage space used for your voice memos.
- 2 List of your voice memos. Touch a voice memo to play it.
- 3 Record/Pause button
  - Touch  to start recording.
  - Touch  to pause recording.
- 4 Stop button
  - Touch  to stop recording. The recorded memo is added to the voice memos list on the left of the screen.
  - You can also press the [] button on the steering wheel.



## Note

---

- Voice memo recording mutes the function in operation or pauses media playback.
- If you make or answer a call while recording a voice memo, the recording pauses. If an emergency call is connected, the recording will stop and the recorded voice memo will be saved automatically.

## Using phone projection

Phone projection enables you to connect your Android smartphone or iPhone to your system and use their functions via the system. You can perform and control your smartphone applications by using the larger screen and enhance your use of the system.



## Caution

---

- Use only applications that are compatible with phone projection. Using incompatible applications may cause problems for your system or smartphone.
- Only compatible applications will be displayed on the phone projection screen. You can also check compatible applications by visiting the following websites:
  - Apple CarPlay: <https://www.apple.com/ios/carplay>
  - Android Auto: <https://www.android.com/auto>

## Connecting your iPhone via Apple CarPlay

Before using Apple CarPlay, be sure to check the following:

### Apple CarPlay support on your iPhone

Visit the Apple homepage (<https://www.apple.com/ios/carplay>) and check the iPhone models that support Apple CarPlay.

### Apple CarPlay activated or updated on your iPhone

On your iPhone, ensure that Apple CarPlay is activated. If your iPhone does not have the function, update the iPhone's operating system to the latest version.

Start Apple CarPlay by following the steps below:

- 1 On the Home screen, touch **All menus** ► **Settings** ► **Phone projection** ► **Apple CarPlay** ► **Enable Apple CarPlay**.

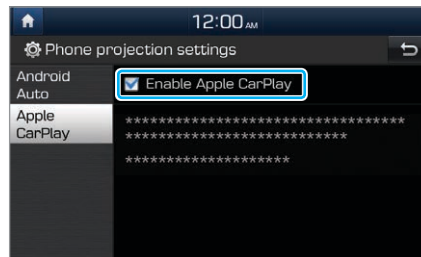

- 2 Connect your iPhone to the USB port in your vehicle via the cable supplied with the iPhone.
  - If you are connecting the device for phone projection for the first time, read the message on the notification pop-up window and touch **OK**.



### Caution

Do not connect and disconnect a USB connector repeatedly in a short time. Doing so may cause an error in the device or a system malfunction.

### 3 If your iPhone is locked, unlock it and agree to use phone projection.

- When the iPhone is recognised successfully, **Apple CarPlay** appears on the Home screen.

### 4 On the Home screen, touch **Apple CarPlay**.



### 5 Use your iPhone's functions, such as calling and messaging, on your system.

- Touch an icon on the screen to run an application or perform a function.
  - Touch the Apple home icon (⓪) to move to the main screen of Apple CarPlay.
  - Touch the **HYUNDAI** icon (Ⓜ) to move to the Home screen of your system.

- Press the [🗨️] button on the steering wheel to start Siri.
- Press the [🎵] button on the steering wheel to select and start a media player installed on your smartphone, in addition to the system's AV modes.
- Press the [📞] button on the steering wheel to answer an incoming call.

### 6 To end Apple CarPlay, remove the USB cable from your system.



#### Note

- When a USB cable is connected to your system, you cannot change the phone projection settings.
- Depending on Apple's policies, applications or functions that are compatible with Apple CarPlay, such as navigation apps or media players, may change. To check compatible applications, visit the Apple homepage (<https://www.apple.com/ios/carplay>).
- To use phone projection in optimised environments, update your smartphone's operating system to the latest version.

- Depending on the connected device's hardware, firmware, and operating system versions, the recognition time may vary.
- Using phone projection may result in mobile communication charges.
- Depending on the network signal status, some functions may not work correctly.
- Avoid controlling your smartphone while phone projection is in use.
- While you are using Apple CarPlay, the following functions are unavailable:
  - Bluetooth
  - USB and iPod modes
  - Volume control (depending on the connected device)
  - Searches using the [↶↷] knob
  - Android Auto

## Connecting your Android smartphone via Android Auto

Before using Android Auto, be sure to check the following:

### Android Auto support on your smartphone

Visit the Google homepage (<https://www.android.com/auto>) and check the regions, device types, and models that support Android Auto.

### Android Auto installed on your smartphone

Download and install the Android Auto application from Google Play. If you are in a region where Android Auto is not supported, you cannot install the application.

Start Android Auto by following the steps below:

- 1 On the Home screen, touch **All menus ▶ Settings ▶ Phone projection ▶ Android Auto ▶ Enable Android Auto.**

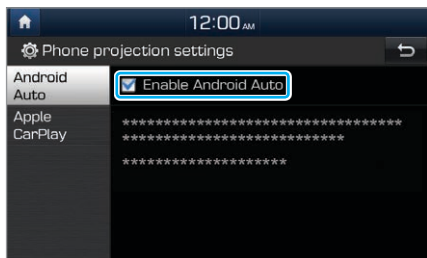

- 2 Connect your smartphone to the USB port in your vehicle via the cable supplied with the smartphone.
  - If you are connecting the device for phone projection for the first time, read the message on the notification pop-up window and touch **OK**.

**! Caution**

Do not connect and disconnect a USB connector repeatedly in a short time. Doing so may cause an error in the device or a system malfunction.

- 3 If your smartphone is locked, unlock it and agree to use phone projection.
  - When the smartphone is recognised successfully, **Android Auto** appears on the Home screen.
- 4 On the Home screen, touch **Android Auto**.
- 5 Use your smartphone's functions, such as calling and messaging, on your system.
  - Touch an icon on the screen to run an application or perform a function.
  - Press the [V] button on the steering wheel to start Google voice recognition.
  - Press the [O] button on the steering wheel to select and start a media player installed on your smartphone, in addition to the system's AV modes.
  - Press the [C] button on the steering wheel to start using Bluetooth call functions.
- 6 To end Android Auto, remove the USB cable from your system.



## Note

---

- When a USB cable is connected to your system, you cannot change the phone projection settings.
- Depending on Google's policies, the icons on the main screen of Android Auto may change.
- Depending on Google's policies, applications or functions that are compatible with Android Auto may change. To check compatible applications, visit the Android homepage (<https://www.android.com/auto>).
- To use phone projection in optimised environments, update your smartphone's operating system to the latest version.
- Depending on the connected device's hardware, firmware, and operating system versions, the recognition time may vary.
- Using phone projection may result in mobile communication charges.
- Depending on the network signal status, some functions may not work correctly.
- Avoid controlling your smartphone while phone projection is in use.
- While you are using Android Auto, the following functions are unavailable:
  - Bluetooth audio
  - USB and iPod modes
  - Searches using the [] knob
  - Apple CarPlay

# Radio

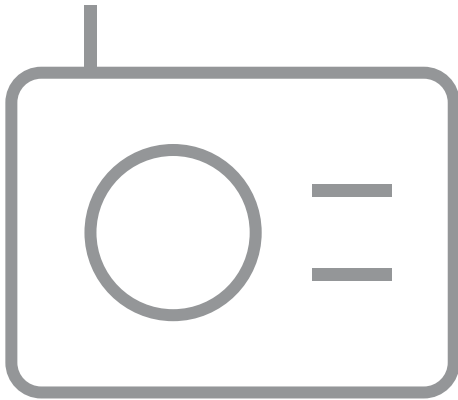

Turning on the radio

Changing the radio mode

Scanning for available radio stations

Searching for radio stations

Saving radio stations

Listening to saved radio stations

# Turning on the radio

On the Home screen, touch **All menus ► Radio**.

The layout of the radio screen may vary depending on your region.



- 1 Select a radio mode.
- 2 Display the options list.
  - **Sound settings:** Customise the system sound settings.  
► See p.7-2 "Setting the system sound."
  - **Manual tune FM:** Tune the radio frequency manually.
  - **Regional:** Enable or disable automatic switching between regional stations.

- 3 Move to the previous screen.
- 4 Radio station information
- 5 Access the preset list.
- 6 Access the list of available radio stations.
- 7 Preview each radio station for five seconds and select the station you want.
- 8 Activate traffic announcements. Announcements and programmes will be received automatically if available.



## Note

- Station names and local information are received via GPS signals. If no GPS signal is received, information may not be displayed.
- Displayed station names may differ from the actual radio stations.



# Changing the radio mode

Select a desired mode at the top of the radio screen.

- Alternatively, press the **[RADIO]** button on the control panel or the **[C]** button on the steering wheel. Each time you press the button, the radio mode switches to DAB/FM ► AM in order.



# Scanning for available radio stations

You can listen to each radio station for a few seconds and select the one you want.

- 1 On the radio screen, touch **Scan**.
  - The system provides a preview of each radio station on the available stations list for five seconds.
- 2 When you find the radio station you want to listen to, touch **Scan** to stop the scan.
  - You can continue listening to the current radio station.



## Note

The system will not add or update the AM radio stations on the available stations list automatically. To add or update the AM radio stations manually, touch **AM ► List ►** .

## Searching for radio stations

To search for the previous or next available radio station, press the [∨ **SEEK**] or [**SEEK** ∧] button on the control panel.

- To select a radio station from the available stations list, touch **List** on the radio screen.
- You can also touch **Menu ► Manual tune FM** and swipe to the left or right on the frequency control bar.

## Saving radio stations

You can save your favourite radio stations and listen to them by selecting them from the preset list.

- 1 On the radio screen, touch **Favourites**.
- 2 Touch and hold an empty slot from the preset list.
  - The radio station you are listening to will be added to the selected slot.





## Note

---

- You can save up to 40 radio stations.
- If a station is already saved to the selected preset number, the station will be replaced by the station you are listening to.
- To sort the preset list in frequency order, touch **Menu ► Auto-sort Favourites**.

## Listening to saved radio stations

- 1 On the radio screen, touch **Favourites**.
- 2 Select one of the radio stations in the preset list.
  - Alternatively, push the [^/∨] lever on the steering wheel to change the radio station.

MEMO



# Media player

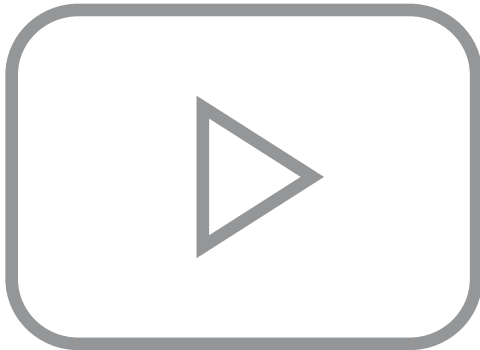

Using the media player

Using the USB mode

Using the iPod mode

Using the AUX mode

4

# Using the media player

You can play music stored in various media storage devices, such as USB storage devices, smartphones, and iPods.

## 1 Connect a device to the USB port or the AUX port in your vehicle.

- Playback may start immediately depending on the device that you connect to the system.

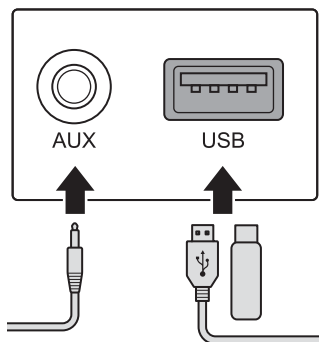

## 2 Touch the AV information area on the Home screen or press the **[MEDIA]** button on the control panel.

- If you have multiple media storage devices, press the **[MEDIA]** button again and select a media mode from the media selection window.

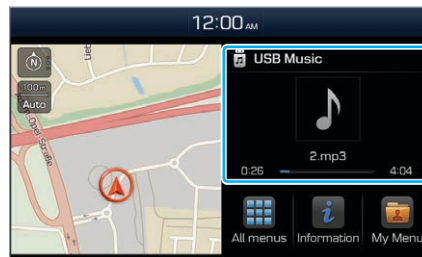

### Note

- When you connect an Apple device, playback does not start automatically and the AV information area remains in the previous mode. You cannot touch the AV information area to start playback. To start the media player in the iPod mode, press the **[MEDIA]** button on the control panel.
- You can also change the mode by pressing the **[O]** button repeatedly on the steering wheel.
- Depending on vehicle models and specifications, available buttons or the appearance and layout of the USB/AUX ports in your vehicle may vary.

## Controlling the media player

Use the buttons at the bottom of the playback screen to control the media player.

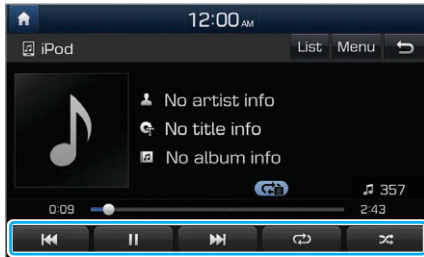

### Pausing/Resuming playback

Touch **⏸** to pause playback. Touch **▶** to resume playing your music.

- You can also press the Mute button on the steering wheel.

#### **Note**

The iPod mode does not support pausing or resuming playback with the Mute button.

### Rewinding/Fast forwarding

Touch and hold **⏮** or **⏭** to rewind or fast forward. Alternatively, press and hold the [**▼ TRACK**] or [**TRACK ▲**] button on the control panel.





- You can also push and hold the [**▲/▼**] lever on the steering wheel.

### Restarting the current playback

Touch **⏮** to restart the song currently playing. Alternatively, press the [**▼ TRACK**] button on the control panel.

- You can also push the [**▲/▼**] lever downward on the steering wheel.

## Playing the previous or next song

To play the previous song, touch  twice or press the [ **TRACK**] button twice on the control panel. To play the next song, touch  or press the [**TRACK** ] button on the control panel.

- You can also use the [/] lever on the steering wheel.



### Note

- On the control panel, turn the [] knob to find the desired song and press the knob within five seconds to play the file.
- If no control is detected within five seconds, the search is cancelled and the screen displays information about the song currently playing.

## Playing repeatedly

Touch  to play a file on repeat. The repeat play mode changes each time you touch it. The corresponding mode icon will be displayed on the screen. Depending on the current media or playlist, available repeat play modes may vary.

## Playing in random order

Touch  to shuffle an album or playlist. The shuffle play mode is activated or deactivated each time you touch it. When you activate the shuffle mode, the corresponding mode icon will be displayed on the screen. Depending on the current media or playlist, available shuffle play modes may vary.



### Note

For specific descriptions of each media mode, refer to the corresponding section. The description on the Bluetooth audio mode is included in the "Bluetooth" chapter.



# Using the USB mode

You can play media files stored in portable devices, such as USB storage devices and MP3 players. Check compatible USB storage devices and file specifications before using the USB mode. ▶ See p.9-8 "USB mode."

## Listening to music

- 1 Connect your USB device to the USB port in the vehicle.
- 2 Touch the AV information area on the Home screen or press the **[MEDIA]** button on the control panel.
  - The media player is displayed in full screen.
  - If you have multiple media storage devices, press the **[MEDIA]** button again and touch **USB Music** from the media selection window.

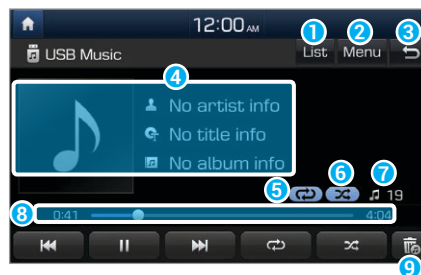

- 1 Access the files list.
- 2 Display the options list.
  - **Sound settings:** Customise the system sound settings. ▶ See p.7-2 "Setting the system sound."
- 3 Move to the previous screen.
- 4 Information about the song currently playing
- 5 Repeat play mode
- 6 Shuffle play mode
- 7 Number of files on the current playlist
- 8 Playback time and playback position
- 9 Delete the file that is playing currently from the system.



## Note

---

Only USB storage devices formatted in FAT16/32 formats support deleting files. You can find the deleted files in the "to\_delete" folder.



## Caution

---

- Start the engine of your vehicle before connecting a USB device to your system. Starting the engine with a USB device connected to the system may damage the USB device.
- Be careful of static electricity when connecting or disconnecting a USB device. A static discharge may cause a system malfunction.
- Be careful not to let your body or external objects contact the USB port. Doing so may cause an accident or a system malfunction.
- Do not connect and disconnect a USB connector repeatedly in a short time. Doing so may cause an error in the device or a system malfunction.
- Do not use a USB device for purposes other than playing files. Using USB accessories for charging or heating may cause poor performance or a system malfunction.



## Note

---

- When connecting a USB storage device, do not use an extension cable. Connect it directly to the USB port. If you use a USB hub or an extension cable, the device may not be recognised.
- Fully insert a USB connector into the USB port. Failure to do so may cause a communication error.
- When you disconnect a USB device, a distorted noise may occur.
- The system can play only files encoded in a standard format.
- The following types of USB devices may not be recognised or work correctly:
  - Encrypted MP3 players
  - USB devices not recognised as removable disks
- A USB device may not be recognised depending on its condition.
- Some USB devices may be incompatible with your system.
- Depending on the USB device's type, capacity, or the format of files, USB recognition time may be longer.
- Depending on the specification, some USB devices may not support charging via a USB connection.

## Searching for music files on a file list

Access a file list to search for and select a song.

- 1 On the music playback screen, touch **List**.
- 2 Touch the screen to open a folder, move to another category, or play a music file.

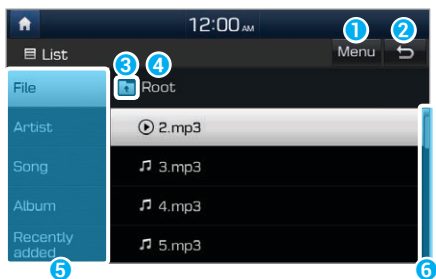

- 1 Display the options list.
  - **Show current track:** Move to the location of the file currently playing while searching for a music file in another folder/category. This option is disabled when a file in the current playlist is playing.

- 2 Move to the previous screen.
- 3 Move up to another folder/category.
- 4 Folder/Category name
- 5 Search for a song based on categories.
- 6 Scroll bar

## Using the iPod mode

You can listen to music stored on your Apple devices, such as an iPod or an iPhone. Check compatible Apple devices and iOS specifications before using the iPod mode. ▶ See p.9-10 "iPod mode."

- 1 Connect your Apple device to the USB port in your vehicle using the cable supplied with the Apple device.
  - When connected, the device will begin charging. Music playback will not start automatically.

## 2 On the control panel, press the [MEDIA] button.

- If you have multiple media storage devices, press the [MEDIA] button again and touch **iPod** from the media selection window.

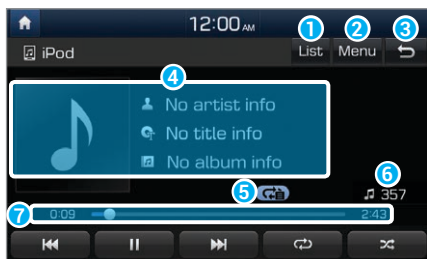

- 1 Access the files list.
- 2 Display the options list.
  - **Sound settings:** Customise the system sound settings. ▶ See p.7-2 "Setting the system sound."
- 3 Move to the previous screen.
- 4 Information about the song currently playing
- 5 Repeat play mode
- 6 Number of files on the current playlist
- 7 Playback time and playback position

## ⚠ Caution

Do not connect and disconnect a USB connector repeatedly in a short time. Doing so may cause an error in the device or a system malfunction.

## ▮ Searching for music files on a file list

Access a file list to search for and select a song.

- 1 On the music playback screen, touch **List**.
- 2 Touch the screen to move to another category or play a music file.

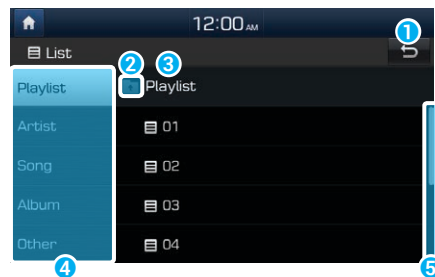

- 1 Move to the previous screen.
- 2 Move up to another category.

- 3 Category name
- 4 Search for a song based on categories.
- 5 Scroll bar

## Notes on connecting Apple devices

- Ensure that the iOS and firmware of your device is up-to-date before connecting it to your system. Outdated devices may cause a system error.
- If your device's battery is low, the device may not be recognised. Check the battery level and, if necessary, charge the battery before connecting the device to your system.
- Use an Apple-approved cable. Using an unapproved cable may cause a distorted noise or an error during playback.
- Fully insert a USB connector into the USB port. Failure to do so may cause a communication error.
- If you connect a media device or mobile phone to your system via both a USB cable and an AUX cable, your system or device may not operate correctly. To use a USB connection, disconnect the AUX cable from the device.

- If you connect your device to the system while playback is in progress on the device, you may hear a high pitch sound just after the connection. Connect the device after stopping or pausing playback.
- Connecting your device during a download or synchronising with iTunes may cause an error. Connect the device after the download or synchronisation is complete.
- If you connect an iPod nano (except for the 6th generation) or an iPod classic, the brand logo will be displayed on the device screen. For an iPhone and an iPod touch, the logo will not be displayed.

## Notes on playing Apple devices

- Depending on the model, your device may not be recognised due to unsupported communication protocols.
- The order of the songs displayed or played on the system may differ from the order of the songs stored in your device.
- Podcasts and audiobooks will play on your system if the dedicated applications are not installed on your Apple device. You can access those files in the **Other** category.

- Podcasts and audiobooks may not play or may not be displayed on your system if your Apple device has iOS 6.0 or later installed.
- In an iPhone, the audio streaming function and iPod mode control may conflict. If an error occurs, disconnect and reconnect the USB cable.
- When using an iPhone or an iPod touch, do not control the device while it is connected to your system. An error may occur.
- If you make or receive a call during playback via an iPhone, the music may remain paused after you end the call. If you do not hear the music after ending a call, check the device to see if the music is paused.
- Do not duplicate a song in multiple folders. One song saved in multiple folders may cause an error with search and playback functions.
- If you perform a media control function, such as stop or repeat, just before a song ends, the song information displayed on the screen may not match the song currently playing. This is not a system error. Restart the iPod mode on the system or pause and resume playback on your device.

## Using the AUX mode

You can listen to audio from your vehicle's speakers by connecting external devices, such as smartphones and MP3 players.

Connect an external device to the AUX port in your vehicle using an AUX cable.

- The AUX mode starts automatically and the sound is heard via your vehicle's speakers.

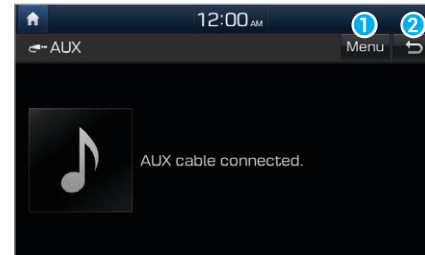

- 1 Display the options list.
  - **Sound settings:** Customise the system sound settings.
    - ▶ See p.7-2 "Setting the system sound."
- 2 Move to the previous screen.



## Note

---

- Because the system works as an output device of the connected external device in the AUX mode, you cannot use controls other than the volume control. Use controls on the external device to control playback.
- The sound volume for the AUX mode is adjusted separately from the other modes.
- Depending on the device type, using an external device with the power cable plugged into the power jack may cause a distorted noise.
- If the AUX cable is plugged into the system without an external device, a distorted noise may occur. Remove the AUX cable from the AUX port when an external device is not connected.

MEMO





# Navigation



- Finding a route quickly
- Finding a route with various search methods
  - Using helpful navigation options
  - Registering locations
- Using the live information service
  - Updating the map
- Changing navigation settings

5

# Finding a route quickly







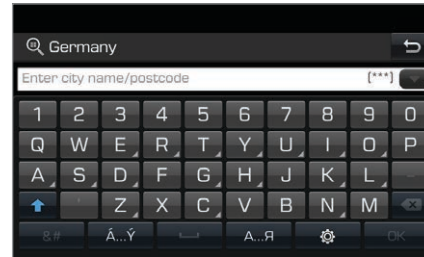

You can find a route to your destination quickly and start the navigation.

- 1 On the Home screen, touch **All menus ► Navigation ► Address**.
- 2 Touch the country field and select a country.



- 3 Touch the text fields and enter information in each field.



- : View the recent keywords list.
- : Switch to the uppercase mode.
- : Delete the entered characters.
- : Switch to the symbol input mode.
- : Switch to the accent input mode.
- : Enter a space.
- : Switch to the Cyrillic alphabet input mode.
- : Change the keyboard settings.

## 4 Touch **Set as destination** ► **Start guidance**.

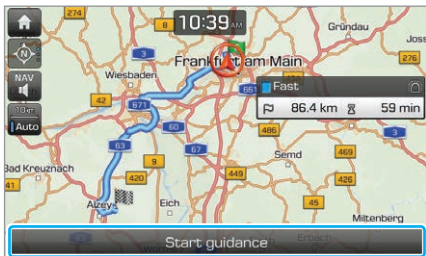

### Note

You can use various search methods available in the navigation menu. On the Home screen, touch **All menus** ► **Navigation**.

► See p.5-8 "Finding a route with various search methods."



### Caution

Depending on the region you are driving in or the driving conditions, information on the map may differ from the actual road conditions.

- When converted to an electronic map, the road shape may be altered. If the navigation guidance is different from the actual road, use your judgment and take the appropriate road.
- The navigation guidance may differ from the actual road due to the time difference between the map production and your driving. Drive according to the current road conditions and traffic regulations. When you reach the section of the route that matches the actual road, the navigation will resume your route correctly.

### Notes on navigation

- The location of your vehicle displayed on the screen may temporarily differ from the actual location in the following situations:
  - When you are driving on a narrow Y-shaped or spiral road
  - When another road is located close to the current road
  - When you are driving on a road with a lot of high buildings nearby

- When you are driving on a road under construction or a new road
- When your vehicle is transported by a car ferry or a towing car
- When you are driving on a road on a steep mountain or a road with a sharp curve
- When your vehicle enters a road after rotating on a turn table of an underground parking lot or a multistorey car park
- When you start and stop repeatedly or drive slowly at an intersection
- When you turn on your system just after charging or replacing the discharged battery
- When you are driving in slippery conditions, such as in heavy sand or snow
- When the tyres have been replaced recently or when studless tyres or spare tyres are used
- When improper-sized tyres are used or the pressure of each tyre is different
- When the replacement tyre is worn, especially studless tyres that have been used for more than two seasons
- When a roof carrier has been installed on your vehicle
- While a long distance route is being calculated on a motorway. In this circumstance, continued driving will enable the system to conduct map matching or use updated GPS information to provide the current location information.

- The navigation guidance may be incorrect temporarily depending on search conditions or your driving position:
  - The navigation may instruct you to go straight when you are driving on a straight road.
  - The navigation guidance may stop while you are driving an intersection or just after turning at an intersection.
  - The navigation may instruct you to take a U-turn at a location where a U-turn is prohibited.
  - The navigation may instruct you to take prohibited roads, such as roads marked as no trespassing or roads under construction.
  - The navigation may instruct you to a distant location from your destination when there is no road or where only narrow roads to the destination exist.
  - The navigation guidance may be incorrect when you are off your route.
  - The navigation estimate to your destination may differ from the actual distance due to the difference in the starting point of the road on a flyover or an underpass.
  - When you are driving at high speeds, route recalculations may take longer.

# Getting to know the navigation screen

You can use the following functions and information on the navigation screen.

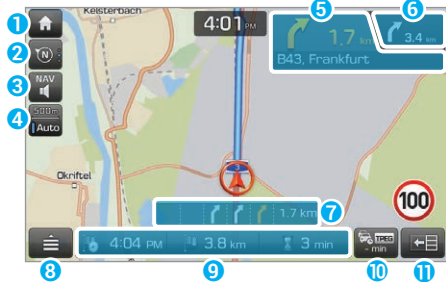

- 1 Move to the Home screen.
- 2 Change how the map is displayed.
  - (2D north up): North is always up.
  - (2D heading up): The map rotates according to your driving direction.
  - (3D heading up): A three-dimension effect is applied and the map rotates according to your driving direction.
- 3 Adjust the navigation sound volume.
- 4 Set to fix the map scale or to set it to change automatically according to driving conditions.

- 5 Information about this turn point
- 6 Information about the next turn point
- 7 Lane guidance
  - Yellow: The recommended lane
  - White: Lanes you can choose
  - Grey: Lanes to avoid
- 8 Display the quick menus you can use for navigation guidance.
- 9 View the estimated arrival time, the distance to the destination, and the remaining duration of the journey. Touch to view detailed destination information.
- 10 Touch to view the traffic information.
- 11 Hide or display the split screen.



## Note

To see the navigation screen without setting a destination, touch the map area on the Home screen or press the **[MAP]** button on the control panel.

## Viewing the split screen

On the split screen, you can view brief information about each section of the route.

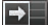
- To hide or display the split screen, touch  or .

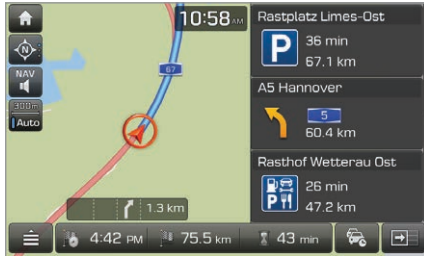

### Note

When you need to take a turn or change lanes, the detailed lane information will be automatically displayed on the screen.



## Changing the default map view settings

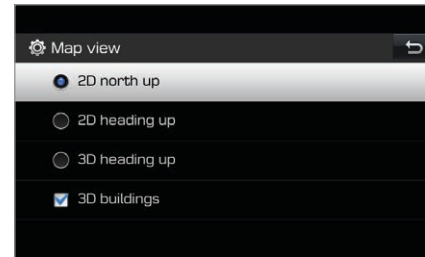

You can change the default view mode of the map screen.

On the Home screen, touch **All menus** ► **Settings** ► **Navigation** ► **Display** ► **Map view** and select a view mode or set to display nearby buildings.



## Adjusting the navigation sound volume

You can adjust the sound volume of the navigation guidance including GPS alert beeps.

Touch  on the navigation screen and touch  or  or drag the adjustment bar to adjust the volume level.

- To mute the voice guidance, touch .



### Note

You can set to use the [] knob or the [+/-] lever to adjust the navigation sound volume while the voice guidance is playing. On the Home screen, touch **All menus** ► **Settings** ► **Sound** ► **Navigation volume** and select **Use map screen volume buttons or volume knob**.

## Canceling the navigation

To stop the navigation guidance and cancel the set destination, touch  ► **Stop guidance**.

- The destination mark at the bottom of the screen disappears.
- To restart the navigation with the previous destination, touch  ► **Resume guidance**.

# Finding a route with various search methods

You can search for a location by various ways, such as entering location information, selecting among categorised locations or the recently selected locations in the navigation menu.

On the Home screen, touch **All menus** ► **Navigation** to access to the navigation menu.

- Alternatively, if your system has the [NAV] button on the control panel, press the [NAV] button.

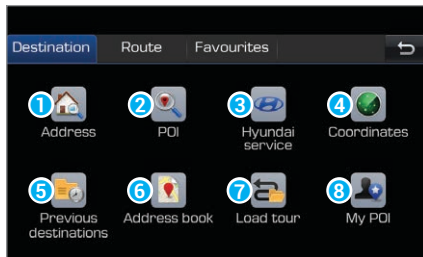

- 1 Search for a location by entering an address. ► See p.5-9 "Searching for locations by address."
- 2 Search for a location by using the point of interest (POI) category. ► See p.5-9 "Searching for locations by POI category."
- 3 Search for a Hyundai service. ► See p.5-11 "Searching for Hyundai services."
- 4 Search for a location by entering coordinates. ► See p.5-11 "Searching for locations by coordinates."
- 5 Select one of the destinations you entered previously. ► See p.5-12 "Selecting a location from previous destinations."
- 6 Select one of locations stored in your address book. ► See p.5-21 "Using the saved locations."
- 7 Select a route that you have saved in the device previously.
- 8 Search for a location by using the imported personal POI data. ► See p.5-12 "Searching for locations by personal POI group."



## Searching for locations by address

- 1 On the navigation menu screen, touch **Address**.
- 2 Touch the country field and select a country.



- 3 Touch the text fields and enter information in each field.
- 4 View the location on the map and touch **Set as destination ► Start guidance**.

## Searching for locations by POI category

You can find a location by using the POI categories or names.

- 1 On the navigation menu screen, touch **POI**.
- 2 Select a search option.
  - To search for a POI by name, touch **Name**.
- 3 Select a POI category.

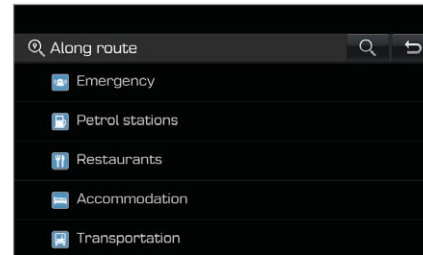

4 Select a sub-category by following the on-screen instructions.

5 Select a location from the search result list.

- To sort the search results, touch the option menu (▼) and select a sorting option.

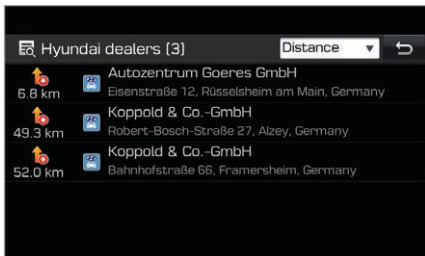

6 View the location on the map and touch **Set as destination** ► **Start guidance**.



### Note

To search for nearby points of interest during the navigation guidance, touch  ► **Nearby POI**.

## Displaying POIs on the map

You can set to display nearby POIs on the map.

1 On the Home screen, touch **All menus** ► **Settings** ► **Navigation** ► **Display** ► **Show POI icon on map**.

2 Select POI categories to display on the map.

- You can add up to four POI categories.

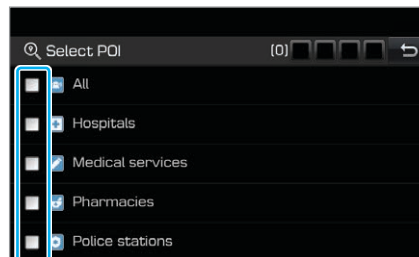

## Searching for Hyundai services

- 1 On the navigation menu, touch **Hyundai service**.
- 2 Select a search option.
  - To search for a POI by Hyundai service name, touch **Name**.
- 3 Select a location from the search result list.
  - To sort the search results, touch the option menu (▼) and select a sorting option.



- 4 View the location on the map and touch **Set as destination ► Start guidance**.

## Searching for locations by coordinates

- 1 On the navigation menu, touch **Coordinates**.
- 2 Select a format option.
  - You can select between DMS (degrees, minutes, seconds), DM (degrees, minutes), or the decimal degree formats.

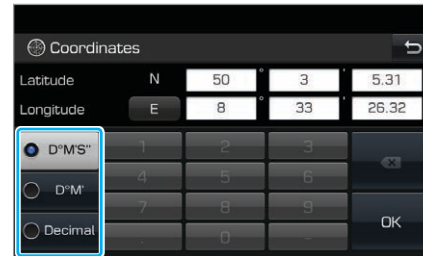

- 3 Enter the latitude and longitude of the location you want and touch **OK**.
- 4 View the location on the map and touch **Set as destination ► Start guidance**.

## Selecting a location from previous destinations

You can select a location from the list of locations you have previously entered.

- 1 On the navigation menu screen, touch **Previous destinations**.
- 2 Select a location.
  - To sort the search results, touch the option menu (▼) and select a sorting option.
  - To delete the locations from a list, touch **Menu ▶ Delete**. You can select and delete locations, or delete all locations at a time.

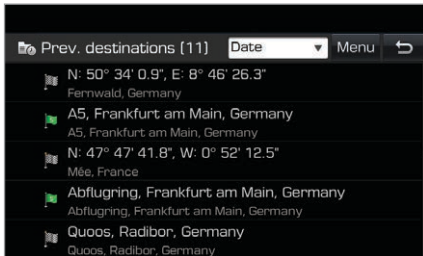

- 3 View the location on the map and touch **Set as destination ▶ Start guidance**.

## Searching for locations by personal POI group

You can import personal POI data that includes map information from a USB storage device and select destinations.

### Importing personal POI data

You can import .kml and .gpx files from a USB storage device.

- 1 Connect your USB device to the USB port in the vehicle.
- 2 On the Home screen, touch **All menus ▶ Navigation ▶ My POI ▶** .
  - Alternatively, on the Home screen, touch **All menus ▶ Settings ▶ Navigation ▶ My data ▶ Import My POI from USB**.

### 3 Touch **Yes**.

- The list of available POI groups is displayed.

### 4 Select a desired POI group from the list and touch **Import**.

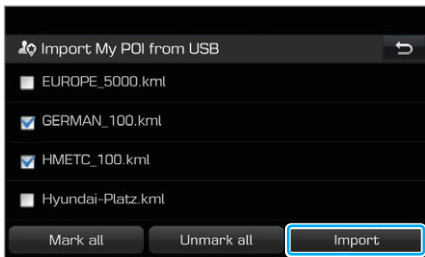

### Note

If you import data that uses different coordinates, the locations of the imported places may be altered.

## | Selecting a location from My POI list

### 1 On the Home screen, touch **All menus** ► **Navigation** ► **My POI**.

### 2 Select the desired POI group.

- To search for a POI group by POI group name, touch .
- To edit the name of a POI on the list, touch **Menu** ► **Edit**.
- To delete POIs from the list, touch **Menu** ► **Delete**.

### 3 Select a location from the list.



### 4 View the location on the map and touch **Set as destination** ► **Start guidance**.

# Using helpful navigation options

## Finding another route

You can change the route options to search for a route again.

- 1 On the navigation screen, touch  ► **Route** ► **Options**.
- 2 Set the route options and touch **OK**.



### Note

Depending on vehicle models or specifications, available options may vary.

## Making a diversion

You can search for a diversion from the current route.

- 1 On the navigation screen, touch  ► **Route** ► **Detour**.

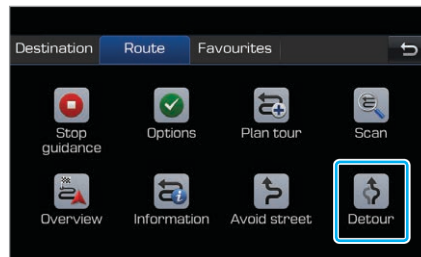

- 2 Touch **Shorter** or **Longer** to set the diversion length and touch **Detour**.
  - The navigation system searches for a new route according to the selected distance.
- 3 Touch **Start guidance**.

## Avoiding specific roads

You can search for a new route that avoids specific roads, such as congested roads and roads under construction.

- 1 On the navigation screen, touch  ► **Route** ► **Avoid street**.

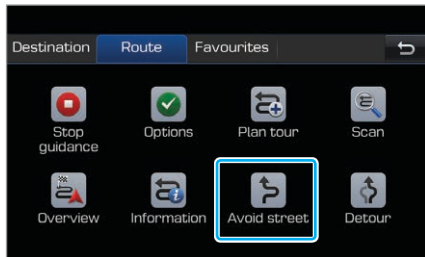

- 2 Select the roads you want to avoid and touch **OK**.

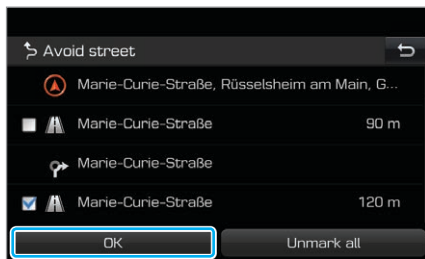

- 3 Touch **Start guidance**.

## Adding waypoints

You can add waypoints to the current route to your destination.

### Searching for and adding waypoints

You can search for a location and add it as a waypoint.

- 1 Search for a waypoint by various search methods. ► See p.5-8 "Finding a route with various search methods."
- 2 View the location and information on the map and touch **Add tourpoint**.

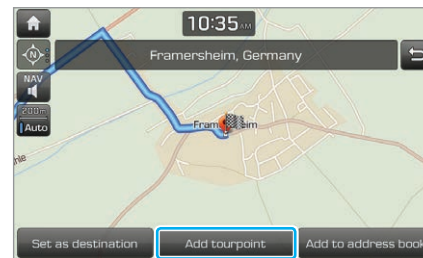

3 Touch **OK**.

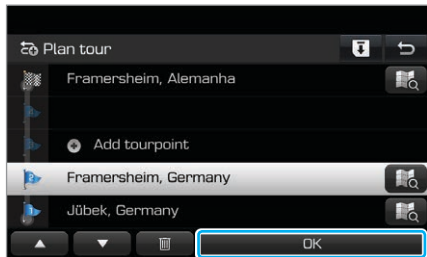

4 Touch **Start guidance**.

## Editing your route

You can edit your route by adding waypoints or rearranging the locations in the route.

1 On the navigation screen, touch  ► **Route** ► **Plan tour**.

2 On the route editing screen, touch **Add tourpoint**.

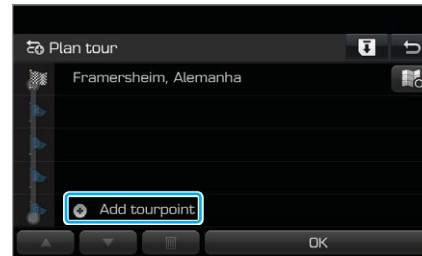

3 Select a search method and search for a location to add it as a waypoint. ► See p.5-8 "Finding a route with various search methods."

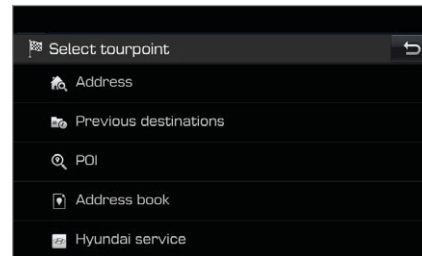



#### 4 Edit the route, if necessary.

- To rearrange the locations, select a location, and drag it to a desired location on the list or touch ▲ or ▼.
- To delete a waypoint, select the location you want and touch ☒.

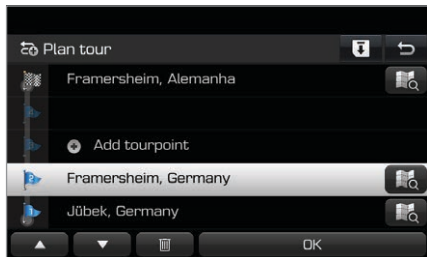

#### 5 When editing your route is complete, touch **OK**.

- To save the current route, touch ☑.

#### 6 Touch **Start guidance**.



#### Note

If you saved the route after editing, on the Home screen, touch **All menus** ► **Navigation** ► **Load tour** to view the saved route.

## Viewing information

During navigation, you can view useful information, such as speed camera locations.

### Viewing speed camera alerts

You can view speed cameras along your route and hear an alert sound when a speed camera is nearby.

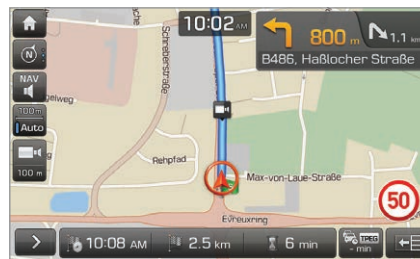



## Note

- Depending on the region or the speed camera type, the image may vary.
- You can send a request related to information updates.
  - If an alert occurs when there is no camera, touch the speed camera indicator to request to delete the camera information.
  - If a speed camera alert does not appear, touch the speed camera report button at that location to request to add camera information.

## Viewing satellite information

You can view GPS satellite status and the coordinates of your current location. Use this information if you need to know your accurate location, such as in an emergency situation.

On the Home screen, touch **All menus** ► **Settings** ► **Navigation** ► **General** ► **Satellite**.

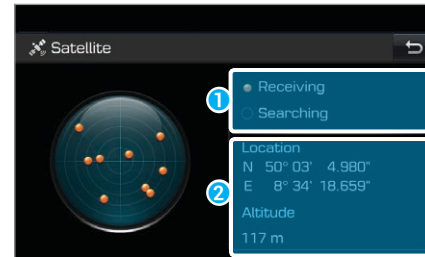

- 1 Current status of satellite signal reception
  - **Receiving:** The system is receiving satellite signals and the current location is recognised.
  - **Searching:** The system is searching for satellite signals.
- 2 Information about your current location

# Registering locations

You can register your current location or desired locations to your address book and select them quickly when setting a destination.

## Saving your current location

You can save your current location quickly.

- 1 On the navigation screen, touch  ► **Add to address book**.

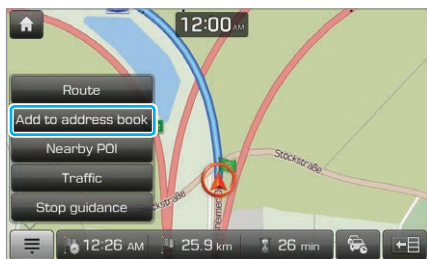

- 2 Edit the location information, if necessary, and touch **OK**.

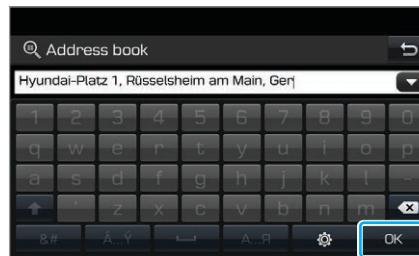

## Searching for and saving locations

You can search for a location and save it to your address book.

- 1 Search for a waypoint by various search methods. ► See p.5-8 "Finding a route with various search methods."

## 2 Touch **Add to address book**.

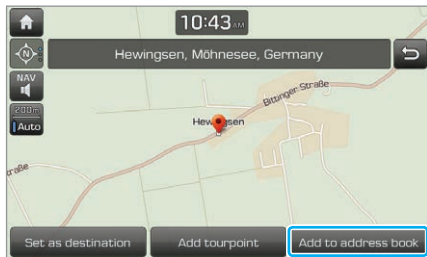

## Saving your favourite locations

You can save your favourite locations, such as your home and workplace, to use navigation guidance more quickly.

- 1 On the Home screen, touch **All menus** ► **Navigation** to access to the navigation menu.
  - Alternatively, if your system has the [NAV] button on the control panel, press the [NAV] button.
- 2 Touch **Favourites**.

## 3 Touch a shortcut button with **+**.

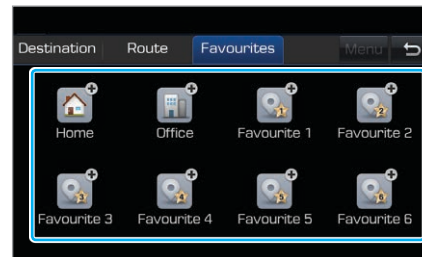

- 4 Touch **Address** and enter a keyword to search for a location.
  - You can use other search methods to find a location.
    - ▶ See p.5-8 "Finding a route with various search methods."
- 5 View the location and information on the map and touch **OK**.
- 6 Change the name of the address entry, if necessary, and touch **OK**.

## Using the saved locations

- 1 On the Home screen, touch **All menus** ► **Navigation** to access to the navigation menu.
  - Alternatively, if your system has the [NAV] button on the control panel, press the [NAV] button.
- 2 Touch **Address book**.
- 3 Select a location from the address book.

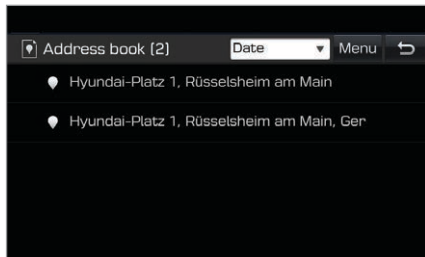

- 4 View the location on the map and touch **Set as destination** ► **Start guidance**.

## Using your favourite locations

If you have set up a list of your favourite locations, you can select one of them directly at the bottom of the screen to set it as your destination.

- 1 On the Home screen, touch **All menus** ► **Navigation** to access to the navigation menu.
  - Alternatively, if your system has the [NAV] button on the control panel, press the [NAV] button.
- 2 Touch **Favourites**.
- 3 Touch a shortcut button where a desired location has been saved.

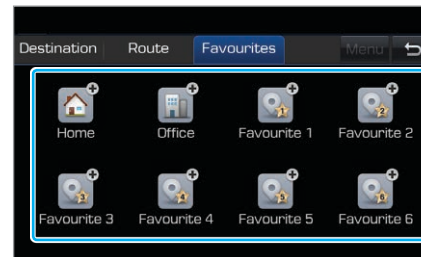

- 4 Touch **Start guidance**.

## Editing saved locations

You can edit information, such as the name and phone number, or change the attributes of the information.

- 1 On the Home screen, touch **All menus** ► **Navigation** to access to the navigation menu.
  - Alternatively, if your system has the [NAV] button on the control panel, press the [NAV] button.
- 2 Touch **Address book**.
- 3 Touch **Menu** ► **Edit**.
- 4 Touch  next to the location name from the address book.
- 5 Edit the information and touch **OK**.

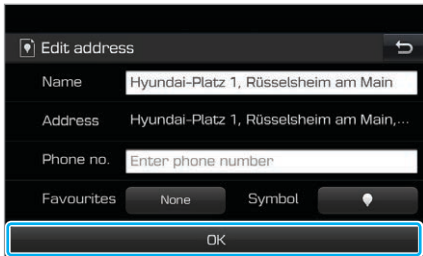

## Deleting saved locations

You can delete saved location information.

- 1 On the Home screen, touch **All menus** ► **Navigation** to access to the navigation menu.
  - Alternatively, if your system has the [NAV] button on the control panel, press the [NAV] button.
- 2 Touch **Address book**.
- 3 Touch **Menu** ► **Delete**.
- 4 Select the location you want to delete and touch **Delete** ► **Yes**.

# Using the live information service

You can view useful information, such as traffic conditions and the weather forecast.

## Viewing traffic information

You can view real-time traffic information including any ongoing road work or accidents.

- 1 On the Home screen, touch **All menus ► Information ► Traffic**.
- 2 Select an item from the traffic information list to view its details.

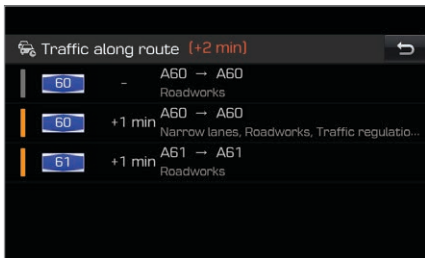

- 3 View detailed traffic information.

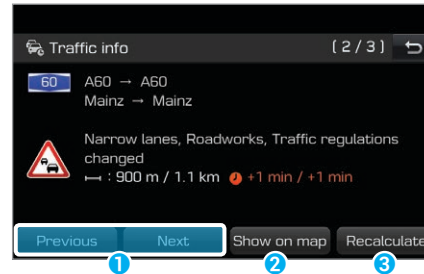

- 1 View the previous or next traffic information.
- 2 View the area on the map.
- 3 Reflect traffic information to your current route.



### Note

Traffic support for border crossings and speed limits set for individual roads may not be accurate. Use the information at your discretion.

## Searching for locations by live POI category

You can find a location by using the live POI names that are updated in real time. Connect to a Wi-Fi network first to use the live information service. ▶ [See p.7-5 "Setting up Wi-Fi."](#)

- 1 On the Home screen, touch **All menus ▶ Information ▶ Live POI.**
- 2 Select a search option.
- 3 Follow the on-screen instructions to search for a location.
- 4 Select a location from the search result list.
- 5 View the location on the map and touch **Set as destination ▶ Start guidance.**

## Viewing weather information

You can view the weather forecast for your current position and destination. Connect to a Wi-Fi network first to use the live information service. ▶ [See p.7-5 "Setting up Wi-Fi."](#)

- 1 On the Home screen, touch **All menus ▶ Information ▶ Weather.**
- 2 Select the desired location.
- 3 Select an item from the weather information list to view its details.
  - To add the selected location as a favourite, touch **Menu ▶ Add.**
- 4 View detailed weather information.



## Viewing weather information for the favourite locations

To save favourite locations and view their weather information easily, on the Weather screen, touch **Favourites**.



- Touch **Menu ► Add** to add a location to the favourites list.
- Touch **Menu ► Delete** to delete saved locations from the favourites list.
- Select a location to view its detailed weather information.

## Searching for parking areas

You can search for parking areas near the selected location, such as your current position and destination.

- 1 On the Home screen, touch **All menus ► Information ► Parking**.
- 2 Select a search option.
- 3 Select a location from the search result list.
  - To sort the search results, touch the option menu (▼) and select a sorting option.
- 4 View the location on the map and touch **Set as destination ► Start guidance**.

## Searching for petrol stations

You can search for petrol stations near the selected location, such as your current position and destination.

- 1 On the Home screen, touch **All menus ► Information ► Petrol stations**.
- 2 Select a search option.
- 3 Select a location from the search result list.
  - To sort the search results, touch the option menu (▼) and select a sorting option.
- 4 View the location on the map and touch **Set as destination ► Start guidance**.

## Updating the map

You can update your navigation map and multimedia system. Please visit your local dealership to update your system.



### Note

- The regular map update schedule varies by location and model. Please contact our dealership for more information.
- Any changes made after the update file is created are not reflected in the map. As a result, certain roads, buildings and speed limits on the map may not be up-to-date.

# Changing navigation settings

You can customise various settings for navigation, such as map view and guidance settings.

On the Home screen, touch **All menus ► Settings ► Navigation.**

---

## General

- **Unit:** Select between miles or kilometres.
  - **Show prev. destinations on start:** Set whether to view previous destinations when the navigation starts up.
  - **Satellite:** View the GPS satellite status.
  - **Current border information:** View information about the current border.
  - **Route simulation:** Simulate the current route when a route is set.
  - **Reset navigation settings:** Reset your navigation settings to the default values.
- 

---

## Display

- **Map view:** Set the default view mode of the map screen.
  - **Show POI icon on map:** Set to display nearby POIs on the map.
  - **Address book symbol:** Set whether to view the address book symbol on the map when a location is saved in the address book.
  - **Speed limit:** Set whether to view speed limit information on the map.
  - **Trace:** Set whether to trace your route on the map.
  - **Reset trace:** Delete trace marks on the map.
-

---

## Guidance

- **Detailed junction view:** Set whether to view junctions in detail.
- **Street name pronunciation:** Set whether to use vocal guidance for street names.
- **Border crossing information:** Set whether to display border information when crossing borders.
- **Lane guidance:** Set whether to use lane guidance.
- **Parking information:** Set whether to display parking information on the map.

---

## My data

- **Import address book from USB:** Import address book data from a USB storage device.
  - **Export address book to USB:** Export your address book data to a USB storage device.
  - **Import My POI from USB:** Import POI data from a USB storage device.
- 



---

## Note

- For importing and exporting address book or POI data, use only USB storage devices formatted in FAT12/16/32 formats.
- If you import data that uses different coordinates, the locations of the imported places may be altered.

# END USER LICENCE AGREEMENT

PLEASE READ THIS END USER LICENCE AGREEMENT ("EULA") CAREFULLY BEFORE USING THE NAVIGATION SYSTEM.

This is a licence agreement between you and Hyundai MnSoft, INC. including its affiliates ("COMPANY") regarding a copy of the COMPANY navigable map database together with associated software, media and explanatory printed documentation published by COMPANY (jointly the "Product"). The Product is provided for your personal, internal use only and not for resale. It is protected by copyright and is subject to the following terms which are agreed to by you, on the one hand, and COMPANY and its licensors (and their licensors and suppliers) (collectively, "Licensors") on the other hand.

By using the Product, you accept and agree to all terms and conditions in this End User Licence Agreement ("EULA"). IF YOU DO NOT AGREE TO THE TERMS OF THIS EULA, YOU MUST PROMPTLY EXIT THE PRODUCT OPERATION PROGRAM AND DO NOT USE OR ACCESS TO THE PRODUCT. YOU AGREE THAT YOUR RIGHTS UNDER THIS EULA MAY BE TERMINATED AUTOMATICALLY WITHOUT NOTICE IF YOU FAIL TO COMPLY WITH ANY TERM(S) OF THIS EULA.

## Terms and Conditions

**Personal Use Only.** You agree to use this Product together with COMPANY's authorised application for the solely personal, non-commercial purposes for which you were licensed, and not for service bureau, time-sharing or other similar purposes. Accordingly, but subject to the restrictions set forth in the following paragraphs, you agree not to otherwise reproduce, copy, modify, decompile, disassemble, create any derivative works of, or reverse engineer any portion of this Data, and may not transfer or distribute it in any form, for any purpose, except to the extent permitted by mandatory laws. You may not assign this EULA or any of the rights or licences granted under this EULA, except when installed in the system for which it was created.

**Restrictions.** Except where you have been specifically licensed to do so by COMPANY, and without limiting the preceding paragraph, you may not use the Product (i) with any products, systems, or applications installed or otherwise connected to or in communication with vehicles, capable of vehicle navigation, positioning, dispatch, real time route guidance, fleet management or similar applications; or (ii) with or in communication with any positioning devices or any mobile or wireless-connected electronic or computer devices, including without limitation cellular phones, palmtop and handheld computers, pagers, and personal digital assistants or PDAs.

**COPYING OR USE OF THE PRODUCT EXCEPT AS PERMITTED BY THIS EULA IS UNAUTHORISED AND IS COPYRIGHT INFRINGEMENT UNDER THE LAWS OF YOUR COUNTRY. IF YOU COPY OR USE THE PRODUCT WITHOUT COMPANY'S PERMISSION, EXCEPT AS PERMITTED BY THIS EULA, YOU ARE VIOLATING THE LAW AND LIABLE TO COMPANY AND ITS LICENSORS FOR DAMAGES, AND YOU MAY BE SUBJECT TO CRIMINAL PENALTIES.**

THE PRODUCT MAY INCLUDE ENFORCEMENT TECHNOLOGY DESIGNED TO PREVENT (i) UNAUTHORISED COPYING OF THE PRODUCT ONTO PHYSICAL STORAGE MEDIA OR VIA TRANSFER OVER THE INTERNET OR OTHER ELECTRONIC COMMUNICATION MEANS AND/OR (ii) ILLEGAL USAGE OF THE PRODUCT OTHER THAN BY A SPECIFICALLY AHTORISED DEVICE. YOU AGREE THAT COMPANY MAY USE THESE MEASURES TO PROTECT COMPANY AND THE LICENSORS AGAINST COPYRIGHT INFRINGEMENT.

**Uploads.** The Product may provide functionality through which you are able to upload certain information about your use of the Product (collectively, "Uploads") to COMPANY's servers or receive other services from COMPANY (collectively, the "Services"). If you use such functionality, you authorise COMPANY to retain your Uploads on its servers. COMPANY will have no obligation to provide any Services, may change the form and nature of any Services at any time with or without notice to you, will have no liability whatsoever to you for any failure of the Product or Services to transmit your Uploads to or from COMPANY's servers, may cease providing any Services at any time with or without notice to you, and will have no obligation to retain your Uploads (or any other materials

you may provide to COMPANY) on its servers or return your Uploads (or any other materials you may provide to COMPANY) to you before deleting them from its servers.

**Storage.** The Product may provide functionality through which you are able to store information (such as images) on the device on which you are using the Product. COMPANY will have no liability whatsoever to you or any third party for any failure of the Product to store any such information on such device.

**Personal Information.** By using the Product, you agree to the collection, retention and processing of your personal data (including the location of your mobile device) by COMPANY and to the storage and processing of such personal information on computers located outside of the country in which you reside. Even though COMPANY has taken steps intended to protect your personal information from being intercepted, accessed, used, or disclosed by unauthorised persons, COMPANY cannot fully eliminate security risks associated with your personal information and cannot guarantee that its systems will not be breached. See [\*] for additional information regarding COMPANY's use of your personal information.

**WARNING. The Product reflects reality as existing before you received the product and it comprises data and information from government other sources. accordingly, the product may contain inaccurate or incomplete information due to the passage of time, changing circumstances, sources used and the nature of collecting comprehensive geographic product, any of which may lead to incorrect results.** THE PRODUCT AND SERVICES MAY NOT TO BE USED FOR SAFETY OF LIFE APPLICATIONS, OR FOR ANY OTHER APPLICATION IN WHICH THE ACCURACY OR

RELIABILITY OF THE PRODUCT OR SERVICES COULD CREATE A SITUATION WHERE PERSONAL INJURY OR DEATH MAY OCCUR. **DO NOT ATTEMPT TO CONFIGURE THE PRODUCT OR INPUT INFORMATION WHILE DRIVING. FAILURE TO PAY FULL ATTENTION TO THE OPERATION OF YOUR VEHICLE COULD RESULT IN DEATH, SERIOUS INJURY, OR PROPERTY DAMAGE. BY USING THE PRODUCT, YOU ASSUME ALL RESPONSIBILITY AND RISK.**

**Disclaimer of Warranty.** The Product is provided to you “as is,” and you agree to use it at your own risk. SUBJECT TO THE APPLICABLE LAWS, COMPANY AND THE LICENSORS MAKE NO GUARANTEES, REPRESENTATIONS OR WARRANTIES OF ANY KIND, EXPRESS OR IMPLIED, ARISING BY LAW OR OTHERWISE, INCLUDING BUT NOT LIMITED TO, content, QUALITY, accuracy, completeness, effectiveness, reliability, PERFORMANCE, MERCHANTABILITY, FITNESS FOR A PARTICULAR PURPOSE, NON-INFRINGEMENT, usefulness, use or results to be obtained from the Product, or that the Product or server will be uninterrupted or error-free, OR THAT ERRORS IN THE PRODUCT OR NONCONFORMITY TO ITS DOCUMENTATION CAN OR WILL BE CORRECTED. YOU ACKNOWLEDGE THAT THE PROVISIONS OF THIS SECTION ARE A MATERIAL INDUCEMENT AND CONSIDERATION TO COMPANY AND THE LICENSORS TO GRANT THE LICENCE CONTAINED IN THIS EULA AND TO PROVIDE YOU WITH ACCESS TO THE SERVICES.

**Limitation of Liability.** TO THE MAXIMUM EXTENT PERMITTED UNDER THE APPLICABLE LAWS, COMPANY AND THE LICENSORS SHALL NOT BE LIABLE TO YOU: IN RESPECT OF ANY CLAIM, DEMAND OR ACTION, IRRESPECTIVE OF THE NATURE OF THE CAUSE OF THE CLAIM, DEMAND OR ACTION ALLEGING ANY LOSS, INJURY OR DAMAGES, DIRECT OR INDIRECT, INCURRED BY YOU OR ANY THIRD PARTY WHICH MAY ARISE IN CONNECTION WITH OR RESULT FROM THE USE OR POSSESSION OF THE PRODUCT; OR FOR ANY LOSS OF DATA, PROFIT, REVENUE, CONTRACTS OR SAVINGS, OR OTHER DIRECT, INDIRECT, INCIDENTAL, SPECIAL OR CONSEQUENTIAL DAMAGES ARISING OUT OF YOUR USE OF OR INABILITY TO USE THE PRODUCT, ANY DEFECT IN THE PRODUCT, OR THE BREACH OF THESE TERMS OR CONDITIONS, WHETHER IN AN ACTION IN CONTRACT OR TORT OR BASED ON A WARRANTY, EVEN IF COMPANY OR THE LICENSORS HAVE BEEN ADVISED OF THE POSSIBILITY OF SUCH DAMAGES AND NOTWITHSTANDING THE FAILURE OF ANY LIMITED REMEDY PROVIDED HEREIN.

**Exclusions.** Some jurisdictions do not allow certain warranty exclusions or the limitation or exclusion of liability, so to that extent the above exclusion may not apply to you. To the extent that COMPANY may not, as a matter of applicable law, disclaim any implied warranty or limit its liabilities, the scope and duration of such warranty and the extent of COMPANY's liability shall be the minimum permitted under such applicable law. The disclaimer of warranty and limitation of liability set forth in this EULA does not affect or prejudice your statutory rights where you have acquired the Product otherwise than in the course of business.

**Third-Party Copyright Notices.** The third-party sourced data has been incorporated into or made a part of the Product and is being sublicensed to you subject to the terms and conditions of this EULA. In this regard, you shall not remove or tamper with any intellectual property rights notice attached or used in relation to data supplied by the Licensors.

**Entire Agreement.** This EULA is the entire agreement between COMPANY (and the Licensors) and you pertaining to the subject matter hereof, and supersedes in their entirety any and all previous written or oral communications or documents (including, if you are obtaining an update, any agreement that may have been included with an earlier version of the Product) with respect to such subject matter.

**Governing Law.** This EULA shall be governed by the laws of the jurisdiction in which you reside at the date of acquisition of the Product. Should you at that moment reside outside the European Union or Switzerland, the law of the jurisdiction within the European Union or Switzerland where you acquired the Product shall apply. In all other cases, or if the jurisdiction where you acquired the Product cannot be defined, the laws of the Republic of Korea shall apply. This EULA will not be governed by the U.N. Convention on Contracts for the International Sale of Goods. The courts competent at your place of residence at the time you acquired the Product shall have jurisdiction over any dispute arising out of, or relating to this EULA, without prejudice to COMPANY's right to bring claims at your then current place of residence.

**Export Control.** You agree not to export or re-export from anywhere any part of the Product in any form except in compliance with applicable export laws, rules and regulations, including but not limited to the laws, rules and regulations administered by the Office of Foreign Assets Control of the U.S. Department of Commerce and the Bureau of Industry and Security of the U.S. Department of Commerce.

**Miscellaneous.** If any provision of this EULA is found to be invalid or unenforceable, it will be enforced to the extent permissible and the remainder of this EULA will remain in full force and effect. Failure by COMPANY to prosecute any right with respect to a default hereunder will not constitute a waiver by COMPANY of the right to enforce rights with respect to the same or any other breach. No refunds or replacements will be permitted on damaged Product.

**U.S. Government End Users.** If the Product is being acquired by or on behalf of the United States Government or any other entity seeking or applying rights similar to those customarily claimed by the United States Government, this Product and related documentation are "Commercial Items" as that term is defined at 48 C.F.R. ("FAR") 2.101. This Product and related documentation are licensed to the United States Government end users (a) only as "Commercial Items" and (b) with only those rights as are granted to all other end users in accordance with this EULA, and each copy of Product delivered or otherwise furnished shall be marked and embedded as appropriate with the following "Notice of Use," and shall be treated in accordance with such Notice:



## NOTICE OF USE

Contractor (Manufacturer/ Supplier) Name:  
Hyundai MnSoft, Inc.

This Product and related documentation are commercial items as defined in FAR 2.101 and is subject to this EULA under which this Product is provided.

© 20XX Hyundai MnSoft. All rights reserved.

If the Contracting Officer, federal government agency, or any federal official refuses to use the legend provided herein, the Contracting Officer, federal government agency, or any federal official must notify COMPANY prior to seeking additional or alternative rights in the Product.

**End-User Terms Required by HERE.** The Product utilizes map data that COMPANY licences from HERE and the following copyright notices apply to such map data (the "HERE Data"):  
© 20XX HERE. All rights reserved.

The HERE Data for areas of Canada includes information taken with permission from Canadian authorities, including: © Her Majesty the Queen in Right of Canada, © Queen's Printer for Ontario, © Canada Post Corporation, GeoBase.®, © Department of Natural Resources Canada. All rights reserved. HERE holds a non-exclusive licence from the United States Postal Service® to publish and sell ZIP+4® information. ©United States Postal Service® 20XX. Prices are not established, controlled or approved by the United States Postal Service®. The following trademarks and registrations are owned by the USPS: United States Postal Service, USPS, and ZIP+4.

The HERE Data for Mexico includes certain data from Instituto Nacional de Estadística y Geografía.

© Bundesamt für Eich- und Vermessungswesen

© EuroGeographics

source: © IGN 20XX – BD TOPO ®

Die Grundlagendaten wurden mit Genehmigung der zuständigen Behörden entnommen

The HERE Data for Great Britain contains Ordinance Survey data © Crown copyright and database right 20XX, and Royal Mail data © Royal Mail copyright and database right 20XX. Copyright Geomatics Ltd.

La Banca Dati Italiana è stata prodotta usando quale riferimento anche cartografia numerica ed al tratto prodotta e fornita dalla Regione Toscana.

Copyright © 20XX; Norwegian Mapping Authority

Source: IgeoE – PortugSpain

Información geográfica propiedad del CNIG

The HERE Data for Sweden is based upon electronic data © National Land Survey Sweden

Topografische Grundlage: © Bundesamt für Landestopographie  
The Here Data for the United Kingdom contains public sector information licensed under the Open Government Licence v1.0 (see for the licence <http://www.nationalarchives.gov.uk/doc/open-government-licence/>) and is adapted from data from the office for National Statistics licensed under the Open Government Licence v.1.0.

© Survey of Israel data source

© Royal Jordanian Geographic Centre. The foregoing notice requirement for Jordan Data is a material term of the Agreement. If Client or any of its permitted sublicensees (if any) fail to meet such requirement, HERE shall have the right to terminate Client's licence with respect to the Jordan Data.

Certain Data for Mozambique provided by Cenacarta © 20XX by Cenacarta

source: © IGN 20XX - BD TOPO ®

The HERE Data for Israel includes certain data from the Survey of Israel ("SOI")

# Bluetooth

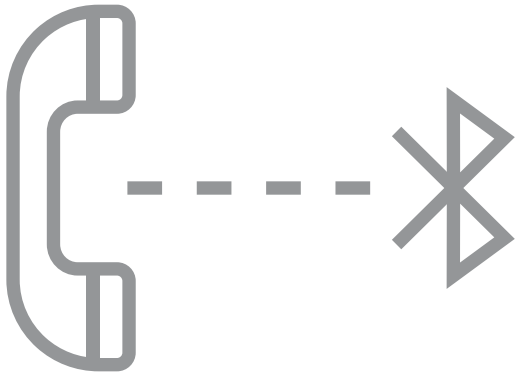

Connecting Bluetooth devices

Using a Bluetooth audio device

Using a Bluetooth phone

# Connecting Bluetooth devices

Bluetooth is a short-range wireless networking technology. Via Bluetooth, you can connect nearby mobile devices wirelessly to send and receive data between connected devices. This enables you to use your devices effectively.

To use Bluetooth, you must first connect a Bluetooth-enabled device to your system, such as a mobile phone or an MP3 player. Ensure that the device you want to connect supports Bluetooth.

## **Warning**

Park your vehicle in a safe location before connecting Bluetooth devices. Distracted driving can cause a traffic accident and lead to personal injury or death.

## **Note**

On your system, you can use only Bluetooth Handsfree and Audio features. Connect a mobile device that supports the Bluetooth Handsfree or Audio feature.

# Pairing devices with your system

For Bluetooth connections, first pair your device with your system to add it to the system's list of Bluetooth devices. You can register up to five devices.

1 On the Home screen, touch **All menus** ► **Settings** ► **Bluetooth** ► **Bluetooth connections** ► **Add new**.

- If you are pairing a device with your system for the first time, you can also press the  button on the steering wheel. Alternatively, on the Home screen, touch **All menus** ► **Phone**.

2 On the Bluetooth device you want to connect, activate Bluetooth, search for your vehicle's system, and then select it.

- Check the system's Bluetooth name, which is displayed in the new registration pop-up window on the system screen.

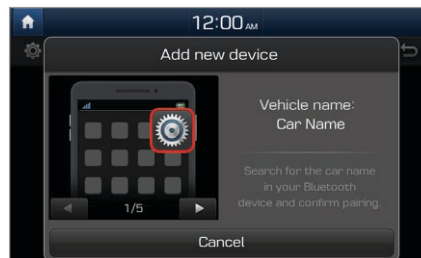

- 3 Ensure that the Bluetooth passkeys displayed on the Bluetooth device screen and the system screen are the same and confirm the connection from the device.
- 4 Choose whether or not to connect the Bluetooth device to your system prior to other devices.
  - If you grant priority to the Bluetooth device, it will be connected automatically to the system when you turn on the system.
- 5 If you are connecting a mobile phone, permit the system to access and download your data from the device.
  - Downloading data is only for Bluetooth call functions. Permission is not required if you are connecting an audio device.



## Note

---

- It may take a while for the system to connect with the device after you permit the system to access the device. When a connection is made, the Bluetooth status icon appears at the top of the screen.
- You can change the permission settings via the mobile phone's Bluetooth settings menu. For more information, refer to your mobile phone's user guide.
- To register a new device, repeat steps 1 to 5.
- When a device is connected to the system via Bluetooth, you cannot pair another device.
- If you do not want the system to connect with the device automatically, deactivate Bluetooth on your device.

## Connecting a paired device

To use a Bluetooth device on your system, connect the paired device to the system. Your system can connect with only one device at a time.

1 On the Home screen, touch **All menus** ► **Settings** ► **Bluetooth** ► **Bluetooth connections**.

2 Touch **Connect** next to the device you want to connect.

- If another device is already connected to your system, disconnect it. Touch **Disconnect** next to the device.

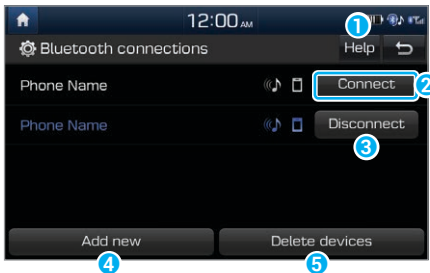

- 1 View Bluetooth help.
- 2 Connect the device.
- 3 Disconnect the device.
- 4 Pair a new device with your system.
- 5 Delete paired devices. Downloaded data from devices will also be deleted.



### Note

- If a connection ends because a device is out of the connection range or a device error occurs, the connection will be restored automatically when the device enters the connection range or when the error is cleared.
- If a connection is unstable due to a communication error, reset Bluetooth by touching **All menus** ► **Settings** ► **Bluetooth** ► **Factory settings**, and then re-connect the device.

## Disconnecting a device

If you want to stop using a Bluetooth device or connect another device, disconnect your currently connected device.

- 1 On the Home screen, touch **All menus ► Settings ► Bluetooth ► Bluetooth connections**.
- 2 Touch **Disconnect** next to the device.
- 3 Touch **Yes**.

## Deleting paired devices

If you no longer want a Bluetooth device paired or if you want to connect a new device when the Bluetooth device list is full, delete paired devices.

- 1 On the Home screen, touch **All menus ► Settings ► Bluetooth ► Bluetooth connections ► Delete devices**.
- 2 Select the devices you want to delete and touch **Delete**.
  - To delete all paired devices, touch **Mark all ► Delete**.
- 3 Touch **Yes**.

# Using a Bluetooth audio device

You can listen to music stored in the connected Bluetooth audio device via your vehicle's speakers.

On the control panel, press the [**MEDIA**] button.

- If you have multiple media storage devices, press the [**MEDIA**] button again and touch **Bluetooth Audio** from the media selection window.



- 1 Display the options list.
  - **Connection settings:** Customise the Bluetooth connection settings. ▶ See p.6-2 "Connecting Bluetooth devices."
  - **Sound settings:** Customise the system sound settings. ▶ See p.7-2 "Setting the system sound."
- 2 Move to the previous screen.
- 3 Information about the song currently playing
- 4 Repeat play mode
- 5 Shuffle play mode
- 6 Restart the current playback. Touch twice to play the previous file. You can also press the [**TRACK** ▼] button on the control panel or use the [^/∨] lever on the steering wheel.
- 7 Pause or resume playback.
- 8 Play the next file. You can also press the [**TRACK** ^] button on the control panel or use the [^/∨] lever on the steering wheel.
- 9 Change the repeat play mode.
- 10 Activate or deactivate the shuffle play mode.





## Note

---

- Depending on the connected Bluetooth device, mobile phone, or the music player you are using, playback controls may differ.
- Depending on the music player you are using, streaming may not be supported.
- Depending on the connected Bluetooth device or mobile phone, some functions may not be supported.
- If you connect a media device or mobile phone to your system via both Bluetooth and a USB or AUX cable, your system or device may not operate correctly. To use a Bluetooth connection, disconnect any cable connection to the device.

## Using a Bluetooth phone

You can use Bluetooth to talk on the phone hands free. View call information on the system screen, and make or receive calls safely and conveniently via the vehicle's built-in microphone and speakers.



## Warning

---

- Park your vehicle in a safe location before connecting any Bluetooth devices. Distracted driving can cause a traffic accident and lead to personal injury or death.
- Never dial a phone number or pick up your mobile phone while driving. Use of a mobile phone may distract your attention, making it difficult to recognise external conditions and reducing the ability to cope with unexpected situations, which may lead to an accident. If necessary, use the Bluetooth Handsfree feature to make a call and keep the call as short as possible.

## Making a call

If your mobile phone is connected to the system, you can make a call by selecting a name from your call history or contacts list. You can also enter a phone number on the keypad.

### 1 On the Home screen, touch **All menus ► Phone**.

- Alternatively, press the [↶] button on the steering wheel.

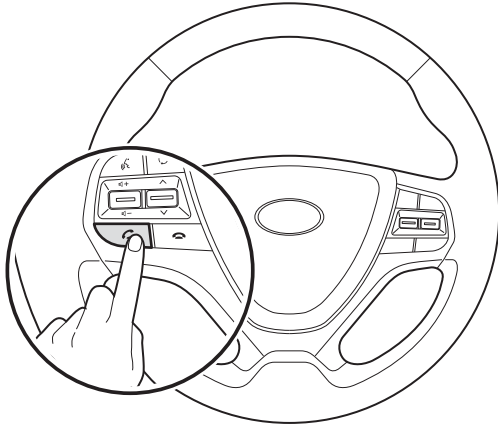

### 2 If you have multiple paired mobile devices, select a mobile phone from your list of paired devices.

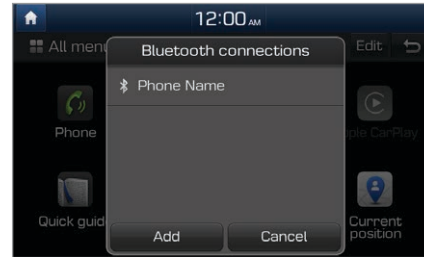

### 3 Select a phone number from your call history.

- You can find the number you want by pushing the [^/∨] lever on the steering wheel. You do not need to touch the screen.
- To select a phone number from your contacts list, touch [👤].
- To enter a phone number manually, touch [12].

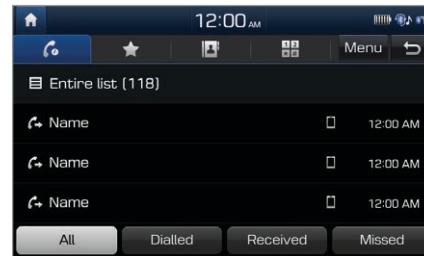

- To end the call, press the [📞] button on the steering wheel or touch **End** on the call screen.

## Using your call history

- On the Bluetooth phone screen, touch .
- Select a call record from the list to make a call.

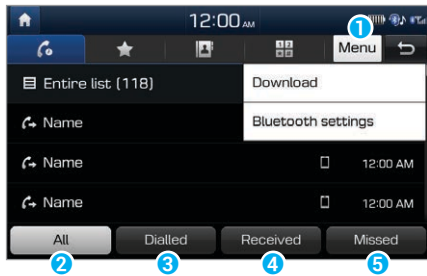

- Display the options list.
  - Download:** Download your call history.
  - Bluetooth settings:** Customise the settings for Bluetooth. ▶ See p.7-5 "Setting Bluetooth."
- View all call records.
- View only dialled calls.
- View only received calls.
- View only missed calls.

## Note

- Some mobile phones may not support the download function.
- Up to 50 call records will be downloaded per individual list.
- Call duration and time information will not be displayed on the system screen.
- Permission is required to download your call history from the mobile phone. When you attempt to download data, you may need to permit the download on the mobile phone. If the download fails, check the mobile phone screen for any notification or the mobile phone's permission setting.
- When you download your call history, any old data will be deleted.

## Using the contacts list

- 1 On the Bluetooth phone screen, touch .
- 2 Select a contact from the list to make a call.

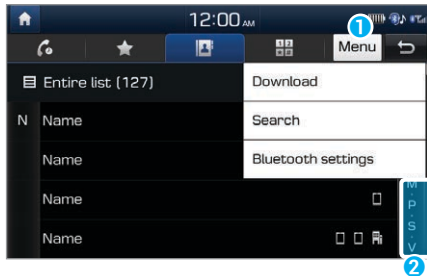



- 1 Display the options list.
  - **Download:** Download your mobile phone contacts.
  - **Search:** Enter a contact's name or phone number to search the list.
  - **Bluetooth settings:** Customise the settings for Bluetooth. ▶ See p.7-5 "Setting Bluetooth."
- 2 Select an initial letter to find contacts quickly.

## Note

- Only contacts in the supported format can be downloaded and displayed from the Bluetooth device. Contacts from some applications will not be included.
- Up to 5,000 contacts can be downloaded from your device.
- Some mobile phones may not support the download function.
- Depending on the system's specifications, some of the downloaded contacts may be lost.
- Contacts stored both in the phone and in the SIM card are downloaded. With some mobile phones, contacts in the SIM card may not be downloaded.
- If you have set up speed dial numbers on the mobile phone, you can make a call by touching and holding a speed dial number on the keypad. Depending on the mobile phone type, the speed dialling function may not be supported.
- Permission is required to download contacts from the mobile phone. When you attempt to download data, you may need to permit the download on the mobile phone. If the download fails, check the mobile phone screen for any notification or the mobile phone's permission setting.

- Depending on the mobile phone type or status, downloading may take longer.
- When you download your contacts, any old data will be deleted.
- You cannot edit or delete your contacts on the system.
- When you connect a new mobile phone, your contacts downloaded from the previous mobile phone will not be displayed, but they will remain in your system until you delete the previous phone from the device list.

## Using the keypad

- 1 On the Bluetooth phone screen, touch .
- 2 Enter a phone number on the keypad and touch  to make a call.

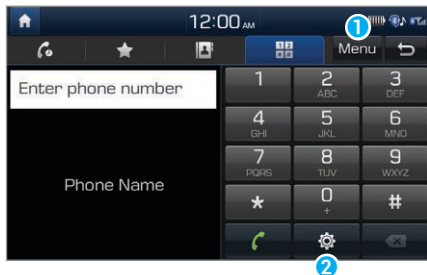

- 1 Display the options list.
  - **Bluetooth settings:** Customise the settings for Bluetooth. ▶ See p.7-5 "Setting Bluetooth."
- 2 Change the settings for Bluetooth connections.

## Answering calls

When a call comes in, a notification pop-up window of the incoming call appears on the system screen.

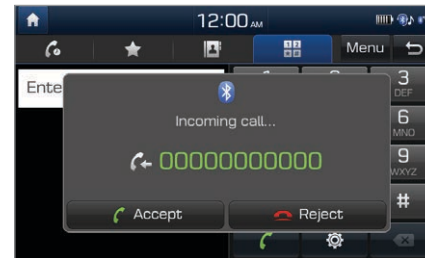

To answer the call, touch **Accept**.

- Alternatively, press the  button on the steering wheel.

To reject the call, touch **Reject**.

- Alternatively, press the [📞] button on the steering wheel.



## Note

- Depending on the mobile phone type, call rejection may not be supported.
- Once your mobile phone is connected to the system, the call sound may be output through the vehicle's speakers even after you exit the vehicle if the phone is within the connection range. To end the connection, disconnect the device from the system or deactivate Bluetooth on the device.

## Using options during a call

During a call, you will see the call screen shown below. Touch a button to perform the function you want.



- 1 Turn off the microphone so the other party cannot hear you.
- 2 Adjust the microphone volume.
- 3 Switch the call to your mobile phone. Depending on the mobile phone type, this function may not be supported.
- 4 End the call.
- 5 Display the keypad.



## Note

---

- If the caller information is saved in your contacts list, the caller's name and phone number will be displayed. If the caller information is not saved in your contacts list, only the caller's phone number will be displayed.
- You cannot switch to any other screen, such as the AV screen or the settings screen, during a Bluetooth call.
- Depending on the mobile phone type, call quality may vary. On some phones, your voice may be less audible to the other party.
- Depending on the mobile phone type, the phone number may not be displayed.

## Switching between calls

If your mobile phone supports call waiting, you can accept a second call. The first call is put on hold.

To switch between the active call and the held call, touch **Switch** or touch the phone number displayed on the call screen.

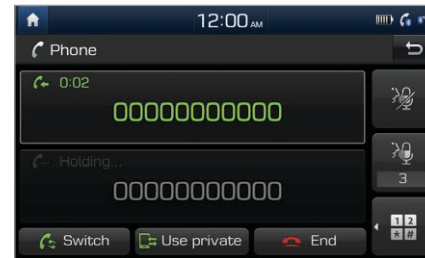

## Note

---

Depending on the mobile phone type, this function may not be supported.

## Setting up your favourites list

If you register frequently used phone numbers as your favourites, you can find them and dial them quickly.

### 1 On the Home screen, touch **All menus ► Phone**.

- Alternatively, press the [🔄] button on the steering wheel.

### 2 On the Bluetooth phone screen, touch **★**.

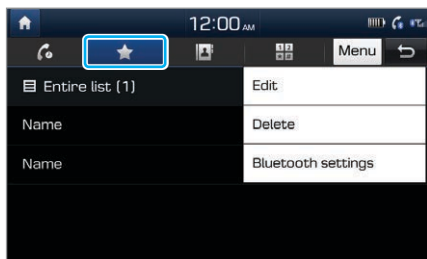

### 3 Touch **Menu ► Edit** and select a contact from your contacts list.

### 4 Touch **★** next to the phone number you want.

- The star icon changes to orange and the phone number is added your favourites list.



### Note

- You can register up to 10 favourites for each device.
- To delete one of your favourites, on the favourites list, touch **Menu ► Delete**.
- When you connect a new mobile phone, your favourites set for the previous mobile phone will not be displayed, but they will remain in your system until you delete the previous phone from the device list.



# Settings

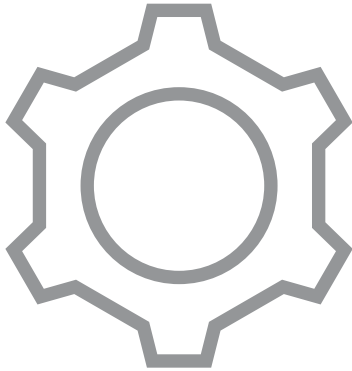

Setting sounds

Setting the system screen

Setting the screen saver

Setting Bluetooth

Setting up Wi-Fi

Setting the system environments

Updating system software and map data

7

# Setting sounds

You can change the settings related to sounds, such as the speaker volume and sound effects.

## Setting the system sound

On the Home screen, touch **All menus ► Settings ► Sound**.



### Note

- Depending on vehicle models or specifications, available options may vary.
- Depending on the system or amplifier specifications applied to your vehicle, available options may vary.

---

<b>Position</b>	Select a location where sound will be concentrated in the vehicle. Touch a desired location on the seat image or touch the arrow buttons to move the focus. To set sound to be centred in the vehicle, touch  .
-----------------	--

---

<b>Volume ratio</b>	Adjust the volume levels for various system features, including phone projection.
---------------------	---

---

<b>Equaliser</b>	Adjust the output level for each sound tone mode.
------------------	---

---

<b>Loudness</b>	<ul style="list-style-type: none"><li>• <b>Navigation prioritised:</b> Set to hear the navigation guidance prior to AV audio when using the navigation and AV functions at the same time.</li><li>• <b>Reverse warning priority:</b> Set to decrease the audio volume to hear a reverse warning prior to other sounds while reversing your vehicle.</li></ul>
-----------------	---

---

- 
- **Navigation during phone calls:** Set to hear the navigation guidance during a call.
  - **Volume limitation on startup:** Set the system to automatically decrease the volume when turned on, if the volume has been set to too high of a level.

---

**Navigation volume**

Select a method to adjust the volume while using the navigation system.

- **Use map screen volume buttons:** You can use the volume adjustment button on the navigation screen.
  - **Use map screen volume buttons or volume knob:** You can use the volume adjustment button on the navigation screen or the [▲] knob on the control panel while the voice guidance is playing.
- 

---

**Advanced** (\*if equipped) Set the advanced sound options or apply various sound effects.

Depending on the amplifier specifications, available sound options and effects may vary.

---

**Default** Reset your sound settings to the default values.

---



---

**Note**

To turn the touch sound on or off, touch **Beep** at the top of the sound settings screen.

## Setting the system screen

You can change the settings for the screen display.

On the Home screen, touch **All menus ► Settings ► Display**.

---

<b>Dimming</b>	Set the screen brightness to be adjusted automatically according to ambient lighting conditions or set the screen to stay bright or dark continuously.
<b>Brightness</b>	Adjust the brightness for the day or night mode according to your setting in the <b>Dimming</b> option.
<b>Default</b>	Reset your screen settings to the default values.

---

## Setting the screen saver

You can select a screen saver option to be displayed when you turn off the screen by pressing and holding the [⏻] button on the control panel.

- 1 On the Home screen, touch **All menus ► Settings ► Screensaver**.
- 2 Select a screen saver option.
  - **Digital:** The digital clock is displayed.
  - **Analogue:** The analogue clock is displayed.
  - **None:** No screen saver is displayed.

# Setting Bluetooth

You can change the settings for Bluetooth connections.

On the Home screen, touch **All menus ► Settings ► Bluetooth.**

---

<b>Bluetooth connections</b>	Pair new Bluetooth devices with your system, or connect or disconnect a paired device. You can also delete paired devices.
<b>Auto connection priority</b>	Select a paired device to connect to your system automatically when it turns on.
<b>System Bluetooth info</b>	View or edit your system's Bluetooth information.
<b>Factory settings</b>	Delete all paired Bluetooth devices and reset your Bluetooth settings to default values. All data related to Bluetooth devices will also be deleted.

---



## Note

Some options will be displayed only when a mobile phone is connected to the system.

# Setting up Wi-Fi

You can use live information services by connecting to a Wi-Fi network. To use the network of a mobile device, such as a smartphone or tablet, turn on the mobile device's hotspot.

1 On the Home screen, touch **All menus ► Settings ► Wi-Fi.**

2 Touch **Wi-Fi** to activate it.

- The system searches for available Wi-Fi networks.

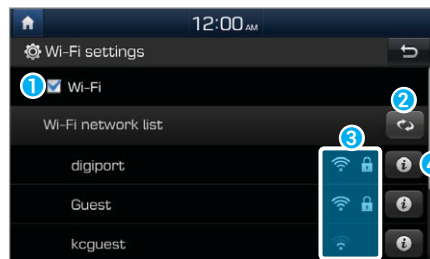

- 1 Turn Wi-Fi on or off.
- 2 Search for available Wi-Fi networks.
- 3 Display the security status of Wi-Fi networks.
  - : Secure network
  - : Open network
- 4 View a Wi-Fi network's information.

### 3 Select a Wi-Fi network from the Wi-Fi network list.

- If you selected a secured Wi-Fi network, enter the password to connect to the network.
- To add Wi-Fi network manually, touch **Add Wi-Fi network**.



#### Note

---

- Once a connection is established, network information is saved and the system will automatically connect to the network in the future.
- You can save the information of up to five Wi-Fi networks.
- To disconnect from a Wi-Fi network, touch the Wi-Fi network on the list and touch **Yes**.
- To delete a saved Wi-Fi network's information, from the Wi-Fi network list, touch  to the right of the network and touch **Forget**.
- You may incur additional data charges by using your mobile device's network, depending on your data plan.
- The battery of your mobile device may drain more quickly when using its Wi-Fi hotspot feature. If possible, charge your mobile device while using live information services.

## Setting the system environments

You can customise system environment settings, such as the time and date, display language, and more.

### Setting the display language

You can change the display language. This setting does not affect the voice guidance for navigation.

1 On the Home screen, touch **All menus ► Settings ► Language**.

2 Select a language.



#### Note

---

This setting will not affect user data, such as MP3 file names.

## Setting the time and date

On the Home screen, touch **All menus ► Settings ► Date/Time.**

---

<b>GPS time</b>	Set to receive time information from the GPS. When you deactivate this option, you can set the time and date manually in the input fields below.
<b>24-hour</b>	Set the time in the 24 hour format.
<b>Daylight saving time</b>	Apply summer time.

---

## Setting the keyboard

You can customise the keyboard settings for text input.

On the Home screen, touch **All menus ► Settings ► Keyboard.**

---

<b>Default keyboard</b>	Select a default character type for the keyboard.
<b>Keyboard type</b>	Select a default keyboard type.

---



### Note

This setting will be applied to all text input on your system.

## Setting advanced options

You can customise additional settings, such as notifications or button functions.

On the Home screen, touch **All menus ► Settings ► Advanced.**

---

<b>Return to map</b>	Select a length of time to return to the map screen automatically if you move to an AV screen while using the navigation system.
<b>Custom button</b>	Select a function to access when you press the custom button [☆] on the control panel.
<b>Steering whl mode button</b>	Select AV modes to access when you press the [⊙] button on the steering wheel.
<b>Media change notifications</b>	Set to briefly display media information at the top of the screen when the next item starts playing if you move from the media player to another function screen.

---

---

### My data

- **Import address book from USB:** Import address book data from a USB storage device.
  - **Export address book to USB:** Export your address book data to a USB storage device.
- 



### Note

- For importing and exporting address book data, use only USB storage devices formatted in FAT12/16/32 formats.
- If you import data that uses different coordinates, the locations of the imported places may be altered.



## Viewing system information

On the Home screen, touch **All menus ► Settings ► System info.**

---

<b>Version info</b>	View your system's version information or update it to the latest version. To update your system, visit your local dealership.
<b>Memory</b>	View storage information of your system's memory.
<b>Default</b>	Reset your system settings to the default values. All user data stored in the system, including navigation history, will also be deleted.

---

## Updating system software and map data

You can update your navigation map and multimedia system. Please visit your local dealership to update your system.



### Note

---

- The regular map update schedule varies by location and model. Please contact our dealership for more information.
- Any changes made after the update file is created are not reflected in the map. As a result, certain roads, buildings, and speed limits on the map may not be up-to-date.
- Depending on the total data amount, an update may take several minutes.
- Do not turn off the system or remove the storage device while the update is in progress. If the power supply is cut off or the storage device is removed from the system, it may damage the data or cause a system malfunction.

MEMO



# Troubleshooting

Solutions



8

# Solutions

Before reporting a malfunctioning system, refer to the following table and see if you can identify and fix the problem. If the problem persists or you are unable to locate your specific need, contact your place of purchase or dealer.

## Sound and display

Symptom	Possible cause	Solution
No sound	System turned off	<ul style="list-style-type: none"><li>• Ensure that the engine start/stop button is set to "ACC" or "ON."</li><li>• Press the [⏻] button to turn on the system.</li></ul>
	Low volume level	Turn the [◀] knob on the control panel to adjust the volume.
	System muted	Press the Mute button on the steering wheel to unmute the system.
Sound is heard from only one speaker.	Unbalanced sound output	On the Home screen, touch <b>All menus ▶ Settings ▶ Sound ▶ Position</b> and change the settings to adjust the sound balance.
Sound is cut off or a distorted noise is heard.	System vibration	It is not a malfunction. If the system vibrates, the sound may be cut off or a distorted noise may occur. When the vibration stops, the system will operate normally.
	AUX cable connected without an external device	If the AUX cable is plugged into the system without an external device, a distorted noise may occur. Remove the AUX cable from the AUX port when an external device is not connected.

Symptom	Possible cause	Solution
The image quality is deteriorated.	Misaligned screen	On the Home screen, touch <b>All menus ► Settings ► Display ► Brightness</b> and adjust the brightness.
	System vibration	It is not a malfunction. If the system vibrates, the image may be distorted. When the vibration stops, the system will operate normally.
	Aged or deteriorated screen	If the problem persists, contact your place of purchase or dealer.
Small red, blue, or green dots appear on the screen.		Because the LCD is manufactured with technology requiring extremely high pixel density, pixel deficiency or constant lighting may occur within the permitted range of less than 0.01 % of the total pixels.

# USB playback

Symptom	Possible cause	Solution
The files on the USB storage device are not recognised.	File format not compatible	Copy compatible media files to the USB device and reconnect the device. ▶ See p.9-8 "USB mode."
	Poor connection	Disconnect the USB storage device from the USB port and reconnect it correctly.
	Contaminated USB connectors	Remove foreign substances from the USB connector of the storage device and the contact surface of the USB port.
	USB hub or extension cable used	Connect the USB storage device directly to the USB port.
	Non-standard USB storage device used	Use a USB storage device that is compatible with the system. ▶ See p.9-8 "USB mode."
	Corrupt USB storage device	Format the USB storage device on a PC and reconnect it. Format the device in FAT12/16/32 format.

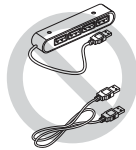

## iPod/iPhone playback

Symptom	Possible cause	Solution
An iPod or iPhone is not recognised in the system.	Poor connection	Disconnect the cable from the USB port and reconnect it correctly.
	Device not ready or malfunctioning	<ul style="list-style-type: none"><li>• Check if the device's battery is low. If the battery is low, the smartphone may not be recognised.</li><li>• Check if the device's firmware is up-to-date. If not, update the firmware via iTunes and reconnect the device.</li><li>• Reset the device and reconnect it.</li></ul>
	Unapproved cable used	Use an Apple-approved cable.
	Device not supported	Use the device types and models that can be played in the system. ▶ See p.9-10 "iPod mode."
No sound is heard during music playback from an iPod or iPhone.	Device connected both to the USB and the AUX port	When the device is connected to the USB port and the AUX port simultaneously, it is recognised in the AUX mode. If the AUX cable is connected to the device, disconnect it.
	Playback paused during a call	If you make or receive a call while playing music from an iPhone, the device pauses playback. The playback may remain paused after you end the call. Check the playback status on the device and resume the audio.

## AUX mode

Symptom	Possible cause	Solution
No sound is heard in the AUX mode.	Poor connection	Disconnect the cable from the AUX port and reconnect it correctly.
A distorted noise is heard in the AUX mode.	Device powered by your vehicle's battery power	Connecting the device with the power cable plugged into the power jack may cause a distorted noise. Unplug the device's power cable from the vehicle.



# Bluetooth connection

Symptom	Possible cause	Solution
The system is not detected on the Bluetooth device.	Pairing mode not activated	On the Home screen, touch <b>All menus ► Settings ► Bluetooth ► Bluetooth connections ► Add new</b> to switch the system to the pairing mode. Then, try searching for the system again on the device.
The Bluetooth device is not connected to the system.	Bluetooth deactivated	Activate Bluetooth on the device.
	Bluetooth error	<ul style="list-style-type: none"><li>• Deactivate Bluetooth and reactivate it on the device. Then, reconnect the device.</li><li>• Turn the device off and on. Then, reconnect it.</li><li>• Remove the battery from the device and reinstall it. Then, turn the device on and reconnect it.</li><li>• Unregister the Bluetooth pairing on both the system and the device and then re-register and connect them.</li></ul>

# Phone projection

Symptom	Possible cause	Solution
Phone projection does not start when a smartphone is connected via a USB cable.	Phone projection not supported by the phone	Visit the following websites and ensure that the smartphone supports the corresponding function. <ul style="list-style-type: none"><li>• Android Auto: <a href="https://support.google.com/androidauto">https://support.google.com/androidauto</a></li><li>• Apple CarPlay: <a href="https://www.apple.com/ios/carplay">https://www.apple.com/ios/carplay</a></li></ul>
	Phone projection disabled	<ul style="list-style-type: none"><li>• On the Home screen, touch <b>All menus ► Settings ► Phone projection</b>, select a function you want to use, and activate it.</li><li>• Check if the function is disabled in the application settings or restriction settings on the smartphone.</li></ul>
	Smartphone not ready or malfunctioning	<ul style="list-style-type: none"><li>• Check if the smartphone's battery is low. If the battery is low, the smartphone may not be recognised.</li><li>• If the network signal is weak, phone projection may not work correctly.</li><li>• If the smartphone is locked, unlock it.</li><li>• Reset the smartphone and reconnect it.</li></ul>
When phone projection starts or is in use, a black screen is displayed.	Smartphone malfunctioning	<ul style="list-style-type: none"><li>• Disconnect the USB cable from the smartphone and reconnect the cable.</li><li>• Reset the smartphone and reconnect it.</li></ul>

## System operation

Symptom	Possible cause	Solution
The previously used media mode is not activated after the system turns off and back on.	Poor connection or playback error	If the corresponding media storage device is not connected or has a problem in playback when you turn on the system, the AV mode you previously used will be activated. Reconnect the media storage device or restart playback.
The system is slow or it does not respond.	Internal system error	<ul style="list-style-type: none"><li>• Press and hold the reset button with a suitable tool, such as a pen or a paperclip.</li><li>• If the problem persists, contact your place of purchase or dealer.</li></ul>
The system does not turn on.	Fuse shorted	<ul style="list-style-type: none"><li>• Visit a repair shop and replace with a suitable fuse.</li><li>• If the problem persists, contact your place of purchase or dealer.</li></ul>

## Navigation system operation

Symptom	Possible cause	Solution
Locations are not found.	Outdated map data	To update your system, visit your local dealership.
The navigation guidance is different from the actual road.	Outdated map data	To update your system, visit your local dealership.
	Road changed after map update	The navigation guidance may be incorrect depending on the build date of the map update, even if the map is updated with the latest data. Drive according to the actual road and traffic regulations.
The navigation provides diversions and the speed camera information is delayed.	Outdated system data or map data	To update your system, visit your local dealership.
Real-time traffic information is not received.	Poor signal reception	<ul style="list-style-type: none"><li>• Receiving traffic information may be poor in some mountainous or island regions. Check the reception status again in a region with strong signals.</li><li>• If the problem persists, contact your place of purchase or dealer.</li></ul>

# Appendix



System status icons

FAQ

System specifications

Index

# System status icons

Status icons appear at the top right of the screen to display the current system status.

Familiarise yourself with the status icons that appear when you perform certain actions or functions and their meanings.

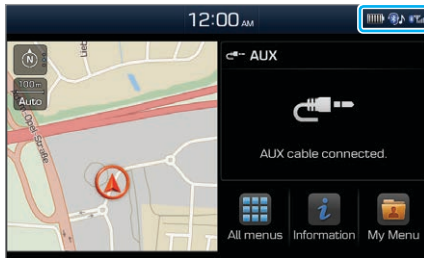

## Mute and voice recording



	Navigation muted
	AV muted
	System muted
	Voice memo recording ▶ See p.2-2 "Using Voice memo."

## Bluetooth



	Battery level of connected Bluetooth device
	Mobile phone connected via Bluetooth
	Audio device connected via Bluetooth
	Mobile phone and audio device connected via Bluetooth
	Bluetooth call in progress
	Microphone turned off during Bluetooth call
	Downloading call history from a mobile phone connected via Bluetooth to the system ▶ See p.6-8 "Making a call."
	Downloading contacts from a mobile phone connected via Bluetooth to the system ▶ See p.6-8 "Making a call."

## Signal strength



Signal strength of the mobile phone connected via Bluetooth

## Data



Connected to a Wi-Fi network



### Note

- The battery level displayed on the screen may differ from the battery level displayed on the connected device.
- The signal strength displayed on the screen may differ from the signal strength displayed on the connected mobile phone.
- Depending on vehicle models and specifications, some status icons may not be displayed.

## FAQ

### Navigation



How do I update the map?



You can download the latest map data by using the SD card provided with your system. ▶ [See p.7-9 "Updating system software and map data."](#)



The navigation system guides me to incorrect bypasses and notifies me the position of speed cameras too late.



You can search for an alternative route by reconfiguring the route options. On the navigation screen, touch  ▶ **Route** ▶ **Options** and set the options and search for other routes. ▶ [See p.5-14 "Finding another route."](#)

If your system is outdated, update the system's software and map data with the latest version. ▶ [See p.7-9 "Updating system software and map data."](#)

# Bluetooth

**Q** What kinds of functions can I use with Bluetooth?

---

**A** You can connect your mobile phone to make or answer calls hands free. You can also connect audio devices, such as MP3 players and mobile phones, to listen to music in your vehicle. ▶ See p.6-7 "Using a Bluetooth phone," p.6-6 "Using a Bluetooth audio device."

**Q** What is the difference between pairing a device and connecting a device?

---

**A** Pairing occurs through authenticating the system and a mobile device. Devices paired with the system can be connected and disconnected until they are deleted from the system. Bluetooth Handsfree features, such as making or answering calls or accessing contacts, are supported only in mobile phones connected with the system.

**Q** How do I pair a Bluetooth device with the system?

---

**A** On the Home screen, touch **All menus ▶ Settings ▶ Bluetooth ▶ Bluetooth connections ▶ Add new**. From the Bluetooth device you want to connect, search for and pair with your system. When you enter or confirm a Bluetooth passkey displayed on the system screen, the device is registered to the system's Bluetooth device list and connected to the system automatically. ▶ See p.6-2 "Connecting Bluetooth devices."

**Q** What is a passkey?

---

**A** A passkey is the password used to authenticate the connection between the system and the mobile device. The passkey needs to be entered only once when you pair a mobile phone for the first time.

The initial passkey is "0000." You can change it by touching **All menus ▶ Settings ▶ Bluetooth ▶ System Bluetooth info ▶ Passkey**.



**Q** I changed my mobile phone that was registered to the system via Bluetooth. How can I register my new mobile phone?

---

**A** You can register additional devices to your system by following the instructions to pair a device. Up to five devices can be added to your system's Bluetooth device list. To delete a registered device, on the Bluetooth device list, touch **Delete devices**, select the devices to delete, and touch **Delete**. ▶ See p.6-2 "Connecting Bluetooth devices."

**Q** How do I answer a call?

---

**A** When a call comes in and a notification pop-up window appears, press the [📞] button on the steering wheel or touch **Accept** on the screen.

To reject the call, press the [📞] button on the steering wheel or touch **Reject** on the screen.

**Q** What should I do if I want to switch the call to my mobile phone while on a call via the system?

---

**A** Press and hold the [📞] button on the steering wheel or touch **Use private** on the screen to switch the call to your mobile phone.

**Q** How do I access the contacts in my mobile phone from the system?

---

**A** When connecting your mobile phone to your system, permit the system to access the contacts saved in the mobile phone. The contacts will be downloaded to the system. To open the downloaded contacts list, press the [📞] button on the steering wheel and touch [👤] on the phone screen. You can search for a contact to make a call or add it to favourites. ▶ See p.6-7 "Using a Bluetooth phone."

**Q** What is the range of my wireless connection?

---

**A** A wireless connection can be used within about 10 m. The maximum Bluetooth range may be affected by the usage environment, such as the vehicle type, the system platform, or the connected mobile phone.

**Q** How many mobile devices can be paired?

---

**A** Up to five devices can be paired with your system.

**Q** Why is call quality sometimes poor?

---

**A** Check your mobile phone's reception sensitivity when call quality deteriorates. The call quality may deteriorate when the signal strength is low.

Call quality may also become poor if metal objects, such as beverage cans, are placed near the mobile phone. Check to see if any metal objects are near the mobile phone.

The call sound and quality may differ depending on the type of mobile phone.

## AV function



**Q** What kinds of AV functions does my system have?

---

**A** Your system provides you with the radio and media player (USB, iPod, AUX, etc.). For more information, see the corresponding chapters.

**Q** I want to move to the previous or next song without touching the screen while driving. How do I do this?

---

**A** Push the [/] lever on the steering wheel to move to the previous or next song.

## Broadcast reception

**Q** No sound is heard or a distorted noise is heard when listening to the radio while driving.

---

**A** Depending on the location, the reception may deteriorate due to obstacles. If the reception diminishes, change the radio station to another one.

Attaching a window film including metal components to the rear window equipped with a glass aerial may lower radio reception.

## How to self-check a system fault

**Q** My system does not operate normally. What should I do?

---

**A** Check your system by referring to the solutions explained in the troubleshooting sections. ▶ [See p.8-2 "Solutions."](#)

If the system still does not operate normally after following the relevant instructions, press and hold the reset button.

If the problem persists, contact your place of purchase or dealer.

# System specifications

## Media player

### USB mode

#### Music

Item	Specifications
Audio file specification	MPEG-1/2 Layer3, OGG (Vorbis), FLAC, WMA (Standard/Professional), WAV
Bit rates/ Sampling frequency	MP3 8 to 320 kbps (CBR/VBR), to 48 kHz (ID3 tag version: Ver. 1.0, Ver. 1.1, Ver. 2.2, Ver. 2.3, Ver. 2.4)
	OGG Q1 to Q10, to 48 kHz
	FLAC 8/16/24 bit, to 48 kHz
	WMA <ul style="list-style-type: none"><li>Standard (0x161): to L3 Profile, to 385 kbps, to 48 kHz</li><li>Professional (0x162): to M0b, to 192 kbps, to 48 kHz</li></ul>
	WAV 8/16 bit, to 48 kHz

Item	Specifications
Detailed specifications	<ul style="list-style-type: none"><li>Maximum number of directory layers: 20</li><li>Maximum length of folder/file names: 255 byte</li><li>Supported characters for folder/file names: Alphanumeric characters, Korean standard character set 2,350 characters, Simplified Chinese 4,888 characters</li><li>Maximum number of folders: 2,000 (including ROOT)</li><li>Maximum number of files: 8,000</li></ul>



#### Note

- You cannot play the following types of files:
  - Modified files (files whose file format has changed)
  - Variant files (for example, MP3 files encoded with WMA audio codec)
  - Files with digital rights management (DRM)
  - Files with no index

- Sound quality of music files using a bit rate in more than 192 kbps is not guaranteed.
- For files that do not use a fixed bit rate, some functions may not work or the playback time may be incorrect.
- If an error occurs when you play a file or the file is not in supported format, change the file format by using the latest encoding software.

### ➤ USB storage devices

Item	Specifications
Byte/Sector	64 kbyte or less
Format system	FAT12/16/32 (recommended), exFAT, NTFS

### Note

- Operation is guaranteed only for a metal cover type USB storage device with a plug type connector.
  - USB storage devices with a plastic plug may not be recognised.
  - USB storage devices in memory card types, such as CF card or SD cards, may not be recognised.

- Any problem caused by the use of USB storage devices not listed in the following table are not covered by the warranty.

Product name	Manufacturer
XTICK	LG Electronics Inc.
BMK	BMK Technology Co., Ltd.
SKY-DRV	Sky Digital Co., Ltd.
TRANSCEND JetFlash	Transcend Information, Inc.
Sandisk Cruzer	SanDisk
Micro ZyRUS	ZyRUS
NEXTIK	Digiworks Co., Ltd.

- USB hard disk drives may not be recognised.
- When you use a large capacity USB storage device with multiple logical drives, only files stored on the first drive will be recognised.
- If an application program is loaded on a USB storage device, the corresponding media files may not play.

## iPod mode

### Supported devices

Device type	Model	Generation
iPod	iPod nano	1G, 2G, 3G, 4G, 5G, 6G, 7G
	iPod touch	1G (except for iOS 1.1), 2G, 3G, 4G, 5G, 6G
	iPod classic	5G (iPod with video), 6G (iPod classic), 6.5G (iPod classic)
iPad	iPad/ iPad mini	Unable to charge, not certified, operation not guaranteed
iPhone		3G (not certified, operation not guaranteed), 3GS, 4, 4S, 5, 5C, 5S, 6, 6+, 6S, 6S+, SE, 7, 7+

### Supported OS

Device type	OS version
iPhone/iPod touch/iPod nano/ iPod classic/iPad/iPad mini	iOS 9.3.2 or earlier

## Common

Item	Specifications
Power supply	DC 14.4 V
Operating power	DC 9 to 16 V
Dark current	1 mA
Operating temperature	-20 to +70 °C (-4 to +158 °F)
Storage temperature	-30 to +80 °C (-22 to +176 °F)
Dimensions	285 x 109 x 140 mm
Current consumption	2.5 A
Weight	1.85 kg

## Display

Item	Specifications
Size	8 inch (176.4 x 99.36 mm)
Pixel number	384,000 pixels (resolution: 800 x 480)
Operating method	Thin Film Transistor (TFT) Active Matrix
Viewing angle	Left/Right, Top/Bottom: 89°
Internal lighting	LED

## Radio

Item	Specifications
Channels A8	<ul style="list-style-type: none"><li>• FM: 87.5 to 108.0 MHz (100 kHz)</li><li>• AM: 522 to 1620 kHz (9 kHz)</li></ul>
Sensitivity	<ul style="list-style-type: none"><li>• FM: 10 dBuV or lower</li><li>• AM: 40 dBu EMF or lower</li></ul>
Distortion factor	2 % or less

## Bluetooth

Item	Specifications
Frequency range	2400 to 2483.5 MHz
Supported Bluetooth specification	3.0
Supported profile	Handsfree (1.6), A2DP (1.2), AVRCP (1.5), PBAP (1.1)
Aerial power	3 mW (maximum)
Number of channels	79
Bluetooth patch RAM software version	1

## Wi-Fi

Item	Specifications
Frequency	2412 to 2472 MHz, 5745 to 5805 MHz
Specification	IEEE802.11a/b/g/n/ac
Supported bandwidth	20 MHz, 40 MHz, 80 MHz
Operating temperature	-20 to +70 °C (-4 to +158 °F)
Maximum WLAN output power	<ul style="list-style-type: none"><li>• 2.4 GHz: 14.02 dBm</li><li>• 5 GHz: 9.61 dBm</li></ul>



# Index

## A

- addresses, search 5-9
- advanced options, set 7-8
- Android devices
  - Android Auto 2-6
- Apple devices
  - Apple CarPlay 2-4
  - iPod mode 4-7
- AUX mode
  - connecting devices 4-2
  - playback 4-10
- AUX port, connect 4-2
- avoiding streets 5-15

## B

- battery warning 1-6
- Bluetooth
  - answering a call 6-11
  - audio 6-6
  - connection
    - connecting devices 6-4
    - deleting devices 6-5

- disconnecting devices 6-5
- pairing devices 6-2
- phone
  - call history 6-9
  - contacts list 6-10
  - favourites list 6-14
  - keypad 6-11
  - making a call 6-8
  - options during a call 6-12
  - switching calls 6-13
- specifications 9-11

## C

- call history 6-9
- calls 6-7
- component names and functions
  - control panel
    - custom button 1-2
    - MEDIA button 1-2
    - Power button/Volume knob 1-2
    - RADIO button 1-2
    - SEEK/TRACK button 1-2
    - SETUP button 1-3

- Tune knob/File knob/Enter button 1-3
- steering wheel remote control
  - call/answer button 1-4
  - call end button 1-4
  - mode button 1-4
  - up/down lever 1-4
  - voice recognition button 1-4
  - volume lever/mute button 1-4
- contacts list 6-10
- control panel 1-2
- coordinates, search 5-11
- current location, save 5-19

## D

- diversion 5-14

## F

- FAQ
  - AV functions 9-6
  - Bluetooth 9-4
  - broadcast reception 9-7

- navigation 9-3
- self-check on system faults 9-7
- favourite locations, save 5-20
- favourite numbers, save 6-14
- finding another route 5-14
- finding routes quickly 5-2
- finding routes with search methods 5-8
- frequently asked questions 9-3

## H

- home screen 1-8

## I

- iPod mode
  - connecting devices 4-2
  - notes on connections 4-9
  - notes on playback 4-9
  - playback 4-7
  - specifications 9-10

## K

- keyboard, set 7-7

## L

- language, set 7-6
- locations
  - deleting 5-22
  - editing 5-22
  - saving 5-19
  - searching for 5-2, 5-8

## M

- map update 7-9
- map view 5-5
  - POI display, set 5-10
- media devices, connect 4-2
- media player
  - AUX mode
    - connecting devices 4-2
    - playback 4-10
  - iPod mode
    - accessing lists 4-8
    - connecting devices 4-2
    - playback 4-7
    - specifications 9-10
  - pausing/resuming 4-3
  - playback 4-3
  - repeat play 4-4

- restarting current playback 4-3
- shuffle play 4-4
- skipping forward/backward 4-4
- USB mode
  - accessing lists 4-7
  - connecting devices 4-2
  - device specifications 9-9
  - music playback 4-5

- multimedia port (USB/AUX) 4-2

- music playback

- AUX mode 4-10
- Bluetooth audio 6-6
- iPod mode 4-7
- media player 4-2
- USB mode 4-5

- My Menu 1-8, 2-2

## N

- navigation 5-2, 5-8
- navigation screen 5-5
- navigation settings 5-27

## P

parking guides 1-9

phone projection

Android Auto 2-6

Apple CarPlay 2-4

POI categories, search 5-9

previous destinations 5-12

## Q

quickly finding routes

notes on navigation 5-3

searching for locations 5-2

## R

radio

mode, change 3-3

saving stations 3-4

scanning stations 3-3

searching for stations 3-4

rear view

parking guides 1-9

reverse warning 1-10

resetting to default

screen 7-4

sound 7-3

system 7-9

reverse warning 1-10

routes

adding waypoints 5-15

adjusting sound volume 5-7

avoiding streets 5-15

cancelling 5-7

diversion 5-14

finding another route 5-14

map view 5-5

map view settings 5-6

navigation settings 5-27

POI display on map 5-10

quickly finding routes 5-2

registering locations

deleting locations 5-22

editing locations 5-22

saving current location 5-19

saving favourites 5-20

searching for and saving  
locations 5-19

searching by address 5-9

searching by coordinate 5-11

searching by POI category 5-9

searching for service stations 5-11

searching from previous  
destinations 5-12

split screen 5-6

updating map data 7-9

## S

satellite information 5-18

saving locations

current location 5-19

favourites 5-20

searches 5-19

screen saver, set 7-4

screen settings 7-4

SD card

precautions 7

searching for locations 5-8

service stations 5-11

settings

advanced options 7-8

Bluetooth 7-5

keyboard 7-7

language 7-6

navigation 5-27

phone projection 2-4, 2-7

- screen saver 7-4
- system information 7-9
- system screen 7-4
- system sound 7-2
- time and date 7-7
- touch sound 7-3
- Wi-Fi 7-5
- software update 7-9
- sound settings 7-2
- specifications
  - Bluetooth 9-11
  - common 9-10
  - display 9-11
  - media player 9-8
  - radio 9-11
  - Wi-Fi 9-12
- split screen 5-6
- steering wheel remote control 1-4
- system information 7-9
- system layout 1-2
- system status icons 9-2
- system, turn on/off 1-5
- system update 7-9

## T

- time and date, set 7-7
- touch screen, control 1-7
- touch sound, set 7-3
- troubleshooting
  - AUX mode 8-6
  - Bluetooth connection 8-7
  - iPod/iPhone playback 8-5
  - navigation operation 8-10
  - phone projection 8-8
  - sound and display 8-2
  - system operation 8-9
  - USB playback 8-4

## U

- update 7-9
- USB device specifications 9-9
- USB mode
  - connecting devices 4-2
  - device specifications 9-9
  - file specifications 9-8
  - music playback 4-5
- USB port, connect 4-2

## V

- voice memos 2-2

## W

- waypoints, add 5-15
- Wi-Fi, set 7-5

# Trademarks

- The Bluetooth® word mark and logos are registered trademarks owned by Bluetooth SIG, Inc. and any use of such marks by HYUNDAI is under licence.



A Bluetooth® Wireless Technology enabled cell phone is required to use Bluetooth® Wireless Technology.

- The Wi-Fi CERTIFIED™ Logo is a certifiemark of Wi-Fi Alliance.



- Google, Android, Android Auto, and Google Play are registered trademarks of Google Inc.
- Apple®, Apple CarPlay™, iPad®, iPad mini™, iPhone®, iPod®, iPod classic®, iPod nano®, iPod touch®, and iTunes® are a registered trademark of Apple Inc.
- Other trademarks and trade names are those of their respective owners.

# CE RED

EU Declaration of Conformity	
<b>Product details</b>	
<b>PRODUCT</b>	DIGITAL CAR AVN SYSTEM
<b>MODEL</b>	AVBCDC8EE, AVBC1C8EE
We hereby declare, that the product above is in compliance with the essential requirements of the Directive 2014/53/EU by application of	
<b>Applied Standards</b>	
<b>Article 3.2</b> Radio	EN 300 328 V2.1.1, EN 303 345 V1.1.7, EN 303 413 V1.1.1, EN 300 440 V2.1.1, EN 303 413 V1.1.1
<b>Article 3.1b</b> EMC	EN 301 489-1 V2.1.1, EN 301 489-17 V3.1.1, EN 301 489-19 V2.1.0, EN 55032:2015, EN 55035:2017
<b>Article 3.1a</b> Safety, Health	EN 60665:2014, EN 62311:2008
<b>Manufacturer</b>	<b>Representative in the EU</b>
Hyundai MOBIS Co., Ltd.	MOBIS Parts Europe N.V.
203, Teheran-ro, Gangnam-gu,	Wilhelm-Fay-Strabe 51,
Seoul, 06141, Korea	Frankfurt Main, 65936, Germany
Tel: +82-31-260-2707	Tel: +49-69-85096-5011
<b>Notified Body</b>	<b>Signed By</b> 25/10/2017
Siemic Inc.	This declaration of conformity is issued under the sole responsibility of the manufacturer.
775 Montague Expressway, Milpitas,	
CA 95035, USA	
<b>Notified Body Identification</b> 2200	 Seunghoon Choe
<b>Reference</b> -	Representative Hyundai MOBIS Co., Ltd.

MEMO



MEMO



MEMO





MEMO



MEMO

